



State of New Jersey  
Department of Environmental Protection  
Geological Survey



**Information Disclaimer**

The State of New Jersey makes great effort to provide secure, accurate and complete information. However, portions of the information contained here may be incorrect or not current.

The State of New Jersey, its officers, employees or agents shall not be liable for damages or losses of any kind arising out of or in connection with the use or performance of information, including but not limited to, damages or losses caused by reliance upon the accuracy or timeliness of any such information, or damages incurred from the viewing, distributing, or copying of those materials.

The materials and information provided here are provided "as is." No warranty of any kind, implied, expressed, or statutory, including but not limited to the warranties of non-infringement of third party rights, title, merchantability, fitness for a particular purpose, and freedom from computer virus, is given with respect to the contents of this document.

OLIVER IRON MINING DIVISION  
 U. S. STEEL CORP.  
 Date: 12-22-29  
 File No. 2-2-29  
 Case No. 10-11-29  
 Drawer No. 4-1-29

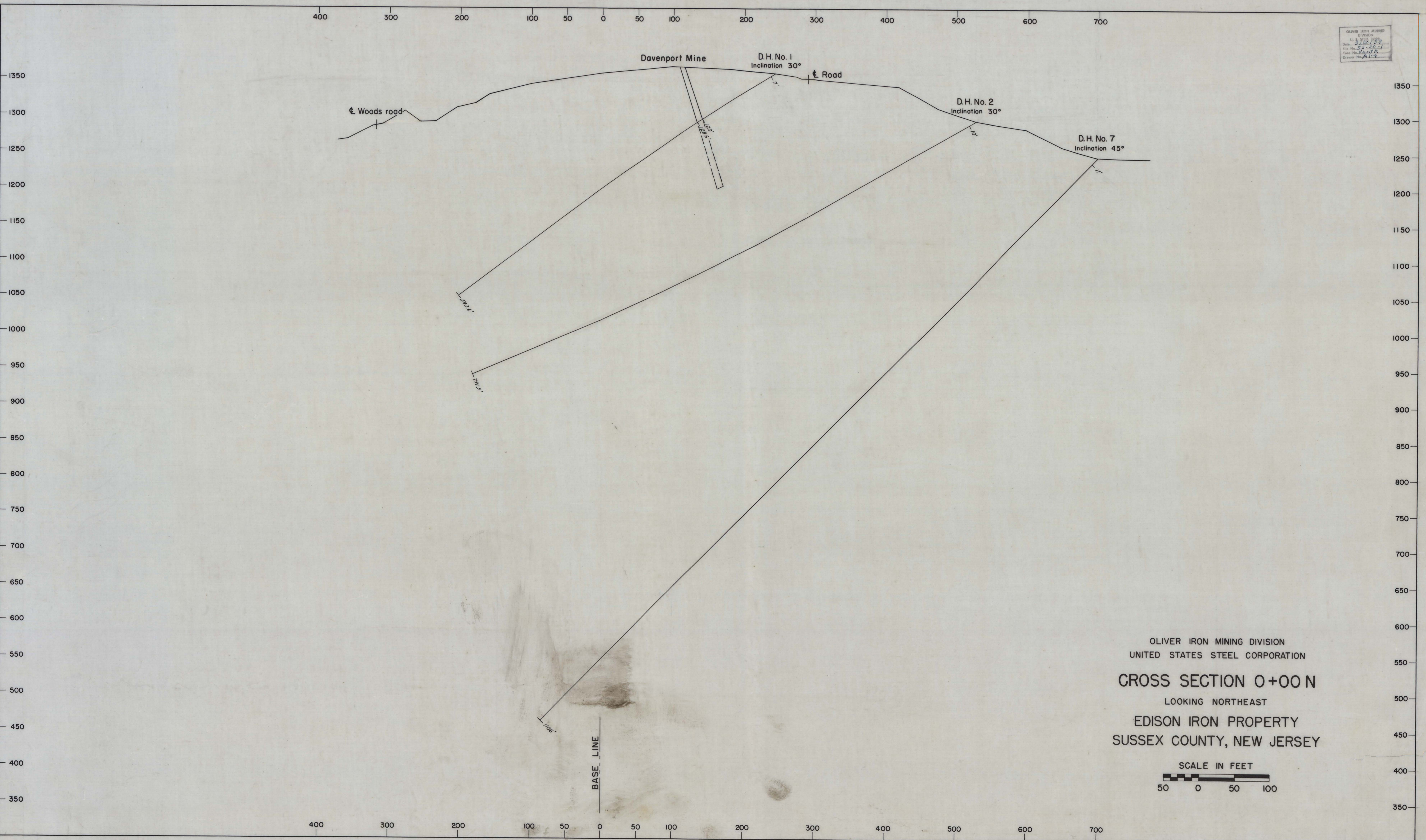

OLIVER IRON MINING DIVISION  
 UNITED STATES STEEL CORPORATION  
**CROSS SECTION 0+00 N**  
 LOOKING NORTHEAST  
 EDISON IRON PROPERTY  
 SUSSEX COUNTY, NEW JERSEY

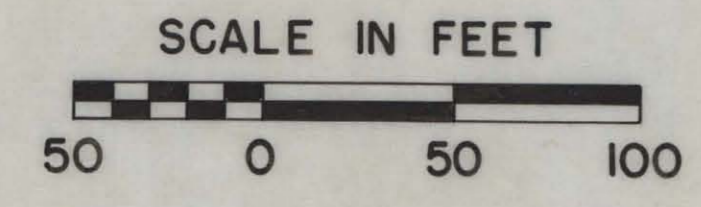

OLIVER IRON MINING DIVISION  
DIVISION  
No. 1  
Date 3/21/28  
File No. 2-25-28  
Case No. 24-1-28  
Drawing No. 2-1-28

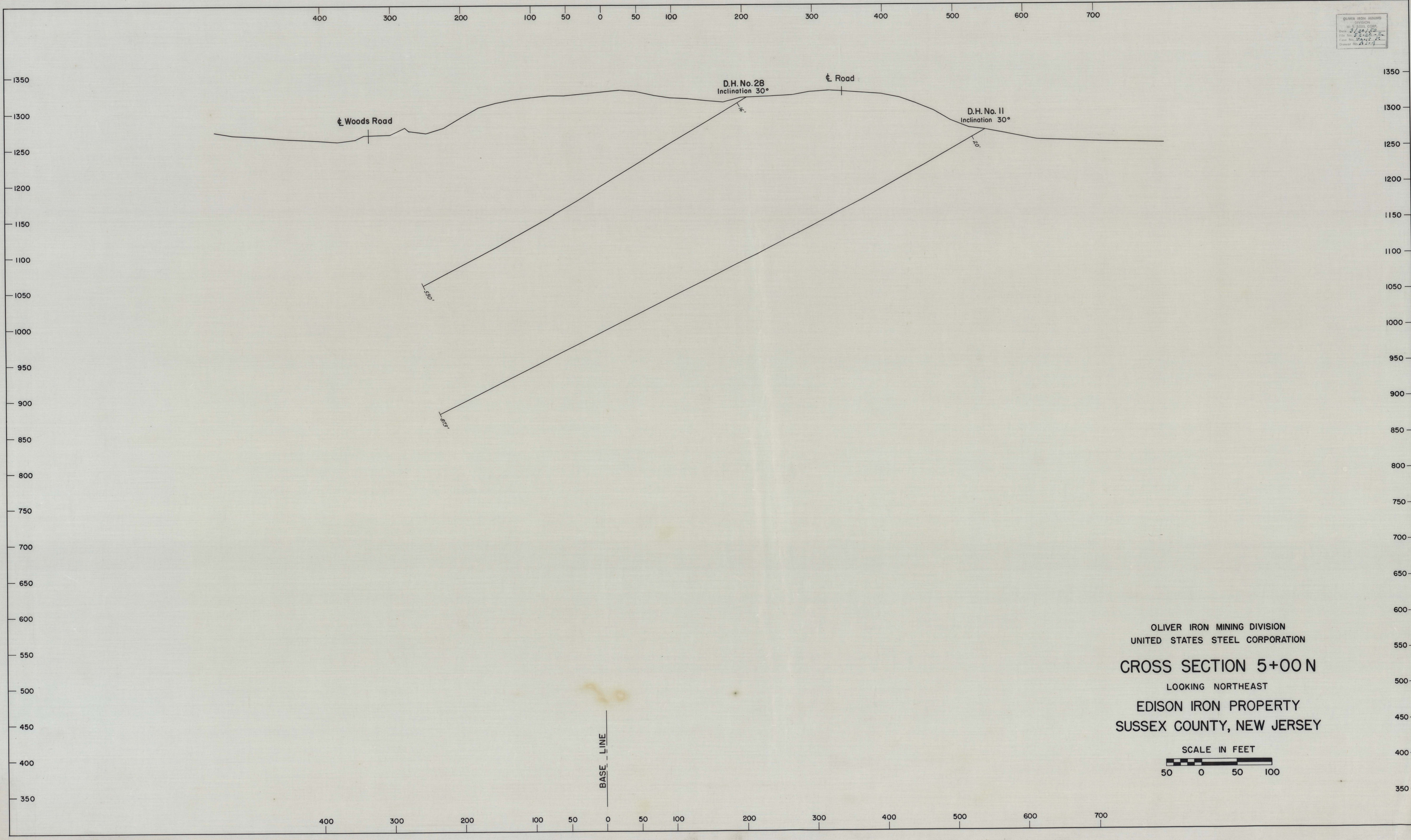

OLIVER IRON MINING DIVISION  
UNITED STATES STEEL CORPORATION  
**CROSS SECTION 5+00 N**  
LOOKING NORTHEAST  
EDISON IRON PROPERTY  
SUSSEX COUNTY, NEW JERSEY

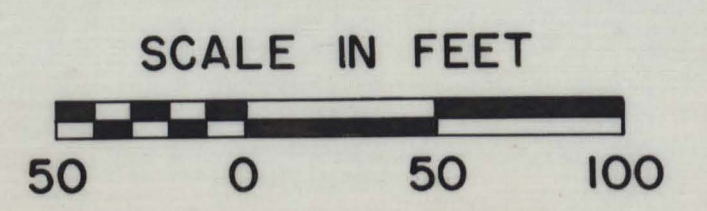

BASE LINE

OLIVER IRON MINING DIVISION  
U.S. STEEL CORP.  
Date: 8/20/23  
File No. 10-22-23  
Case No. 10-112-11  
Drawing No. A-1-1

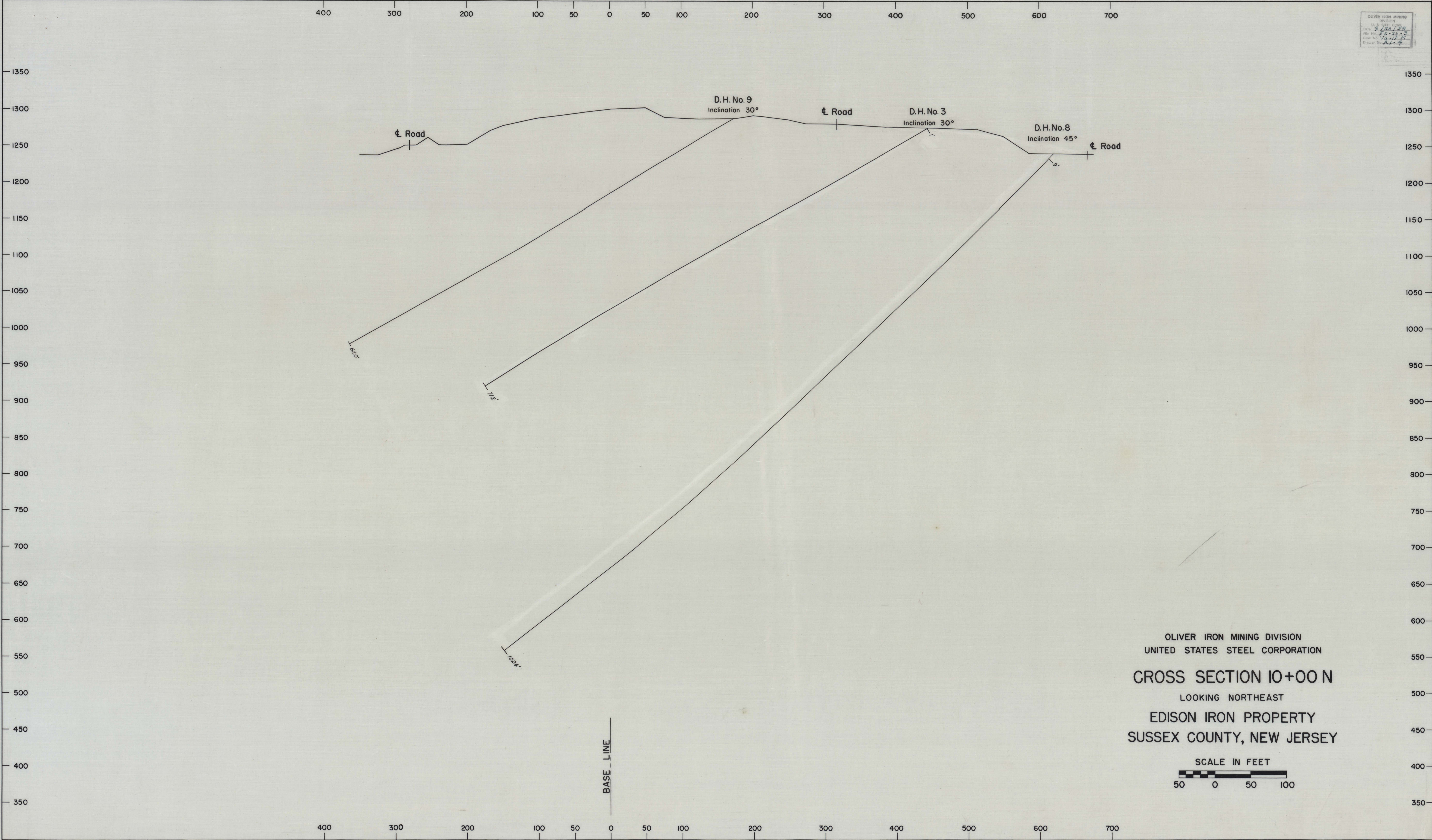

OLIVER IRON MINING DIVISION  
UNITED STATES STEEL CORPORATION  
**CROSS SECTION 10+00 N**  
LOOKING NORTHEAST  
EDISON IRON PROPERTY  
SUSSEX COUNTY, NEW JERSEY

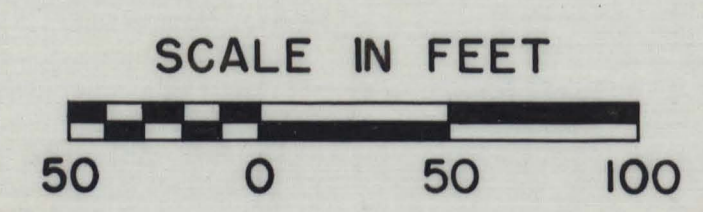

OLIVER IRON MINING DIVISION  
U. S. STEEL CORP.  
Date: 8/20/57  
File No: 15-20-7  
Case No: 15-20-7  
Drawer No: A1-1

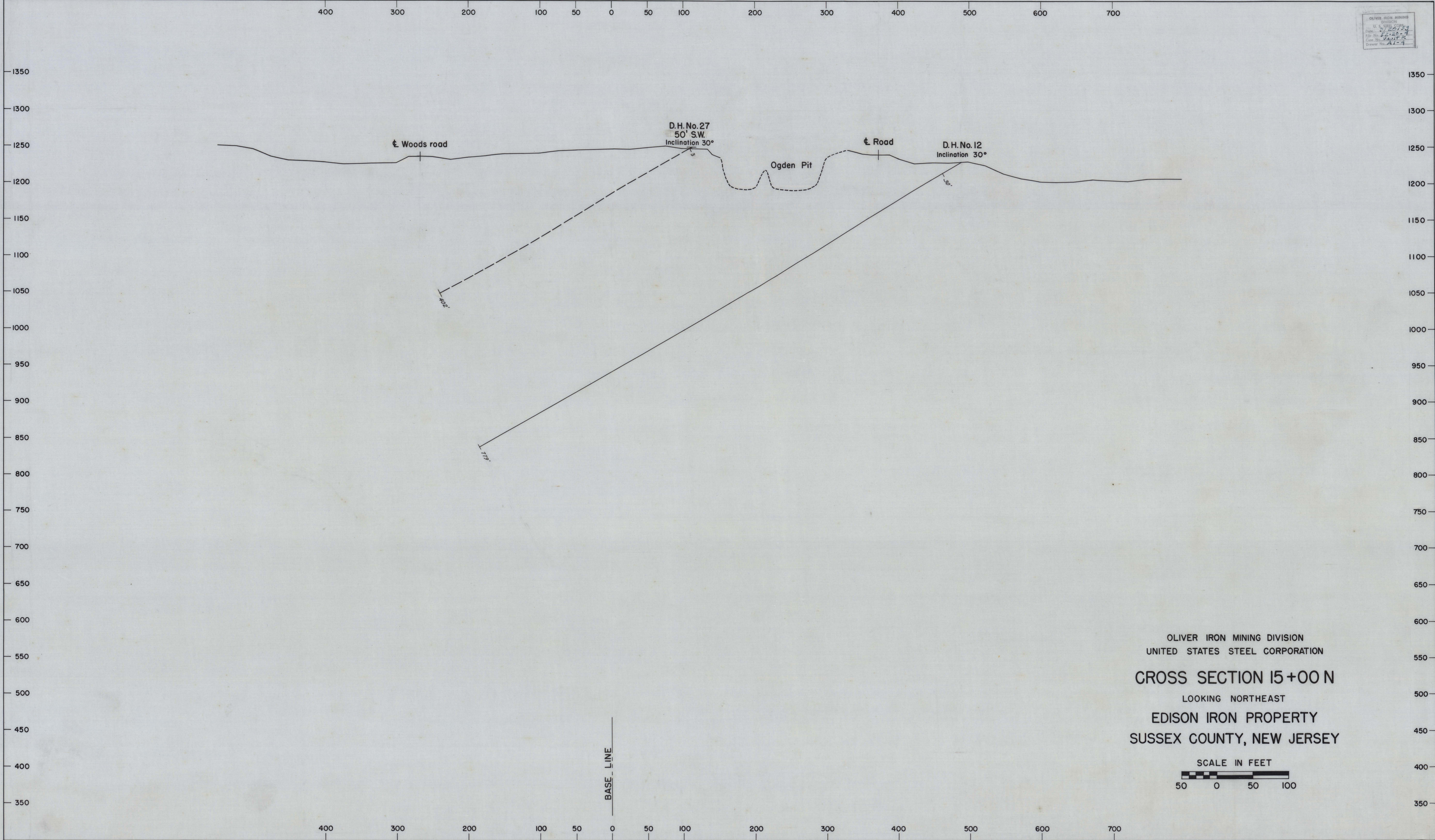

OLIVER IRON MINING DIVISION  
UNITED STATES STEEL CORPORATION  
**CROSS SECTION 15+00 N**  
LOOKING NORTHEAST  
EDISON IRON PROPERTY  
SUSSEX COUNTY, NEW JERSEY

SCALE IN FEET  
50 0 50 100

OLIVER IRON MINING DIVISION  
DIVISION  
Date: 8/28/29  
File No: 55-22-5  
Case No: 10175  
Sheet No: A-1-2

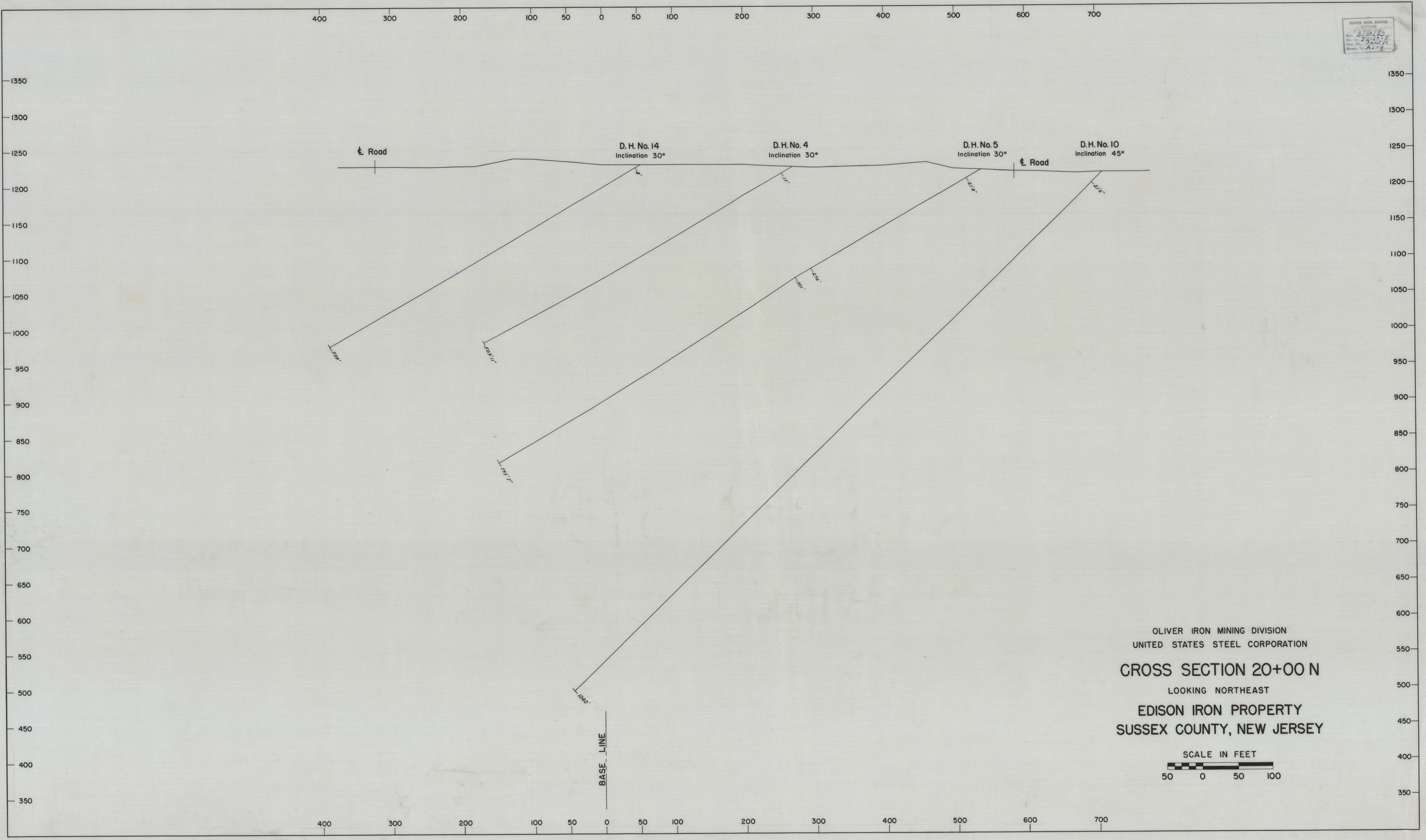

OLIVER IRON MINING DIVISION  
UNITED STATES STEEL CORPORATION  
**CROSS SECTION 20+00 N**  
LOOKING NORTHEAST  
EDISON IRON PROPERTY  
SUSSEX COUNTY, NEW JERSEY



OLIVER IRON MINING DIVISION  
D. H. No. 26  
Date: 2/20/52  
Case No. 22-10-6  
Drawer No. A124

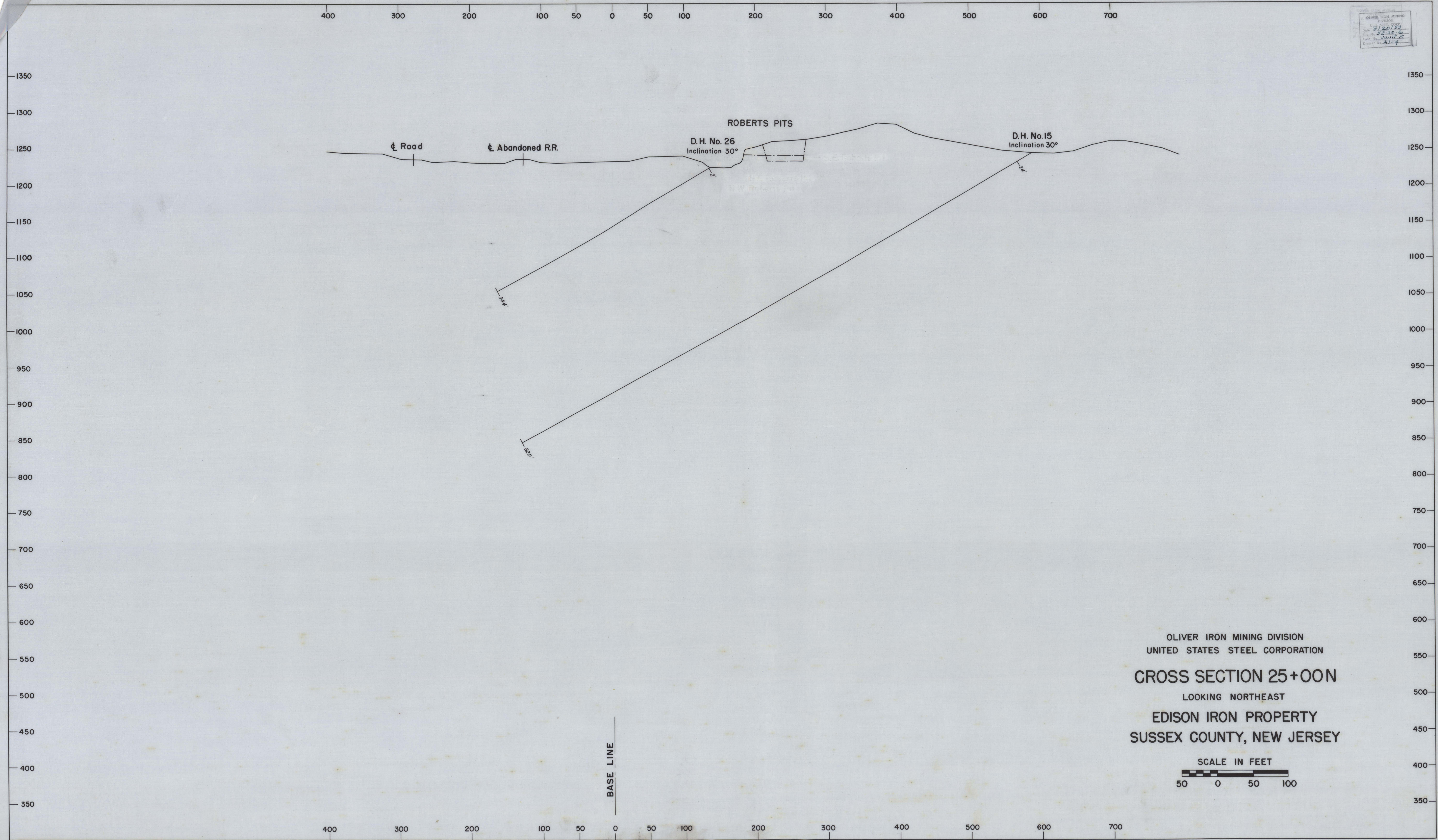

OLIVER IRON MINING DIVISION  
UNITED STATES STEEL CORPORATION  
**CROSS SECTION 25+00N**  
LOOKING NORTHEAST  
EDISON IRON PROPERTY  
SUSSEX COUNTY, NEW JERSEY

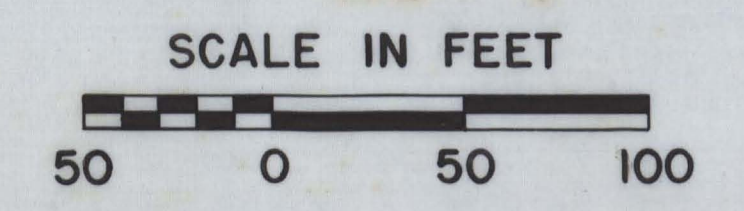

OLIVER IRON MINING DIVISION  
Date: 2/20/23  
File No. 22-56  
Case No. 22-56  
Drawing No. A1-2

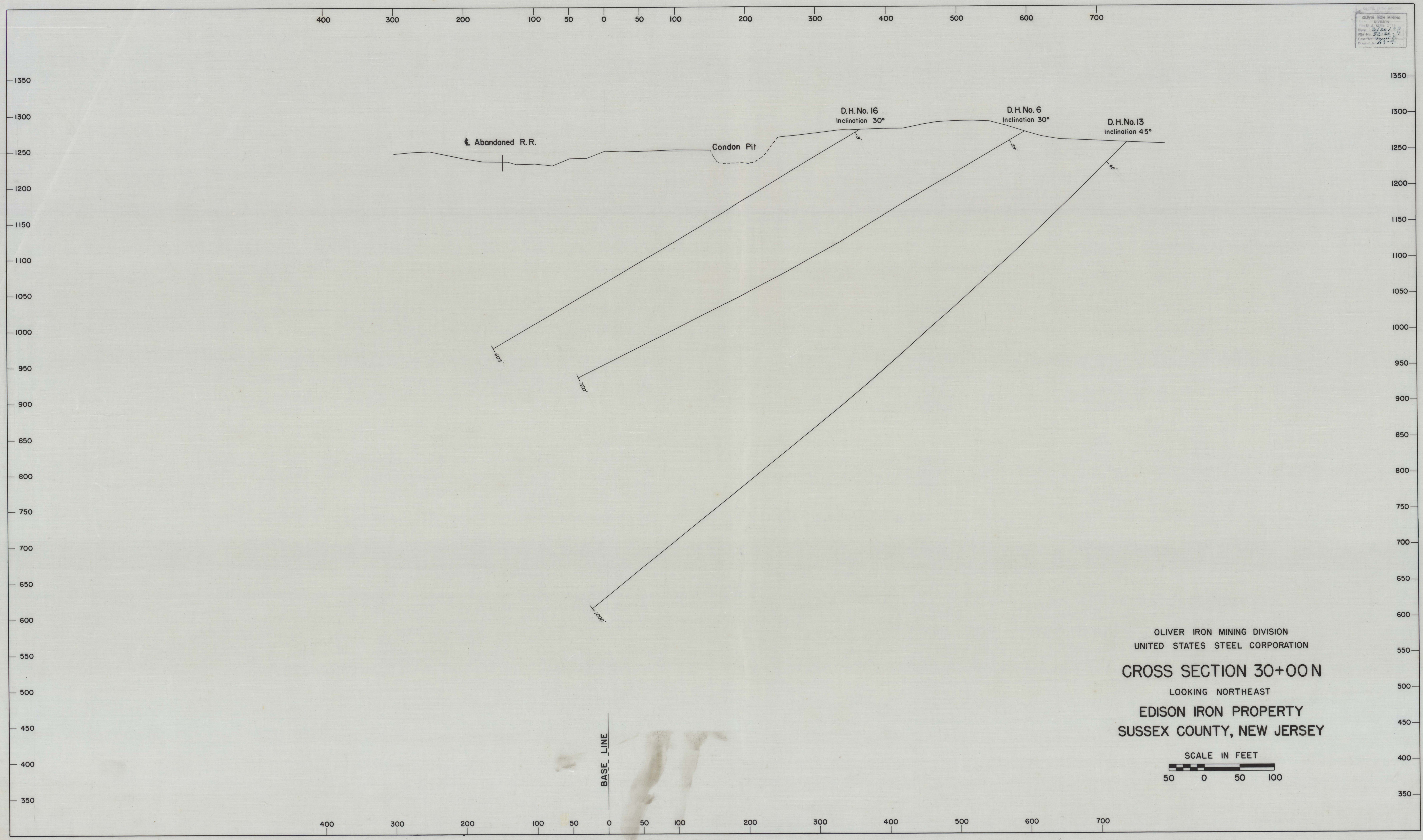

OLIVER IRON MINING DIVISION  
UNITED STATES STEEL CORPORATION  
**CROSS SECTION 30+00N**  
LOOKING NORTHEAST  
EDISON IRON PROPERTY  
SUSSEX COUNTY, NEW JERSEY

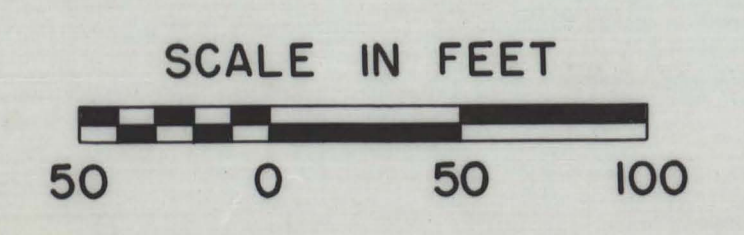



OLIVER IRON MINING DIVISION  
U. S. STEEL CORP.  
Date: 2/12/63  
File No. 52-50-8  
Case No. 10-11-6  
Drawer No. A-1-4

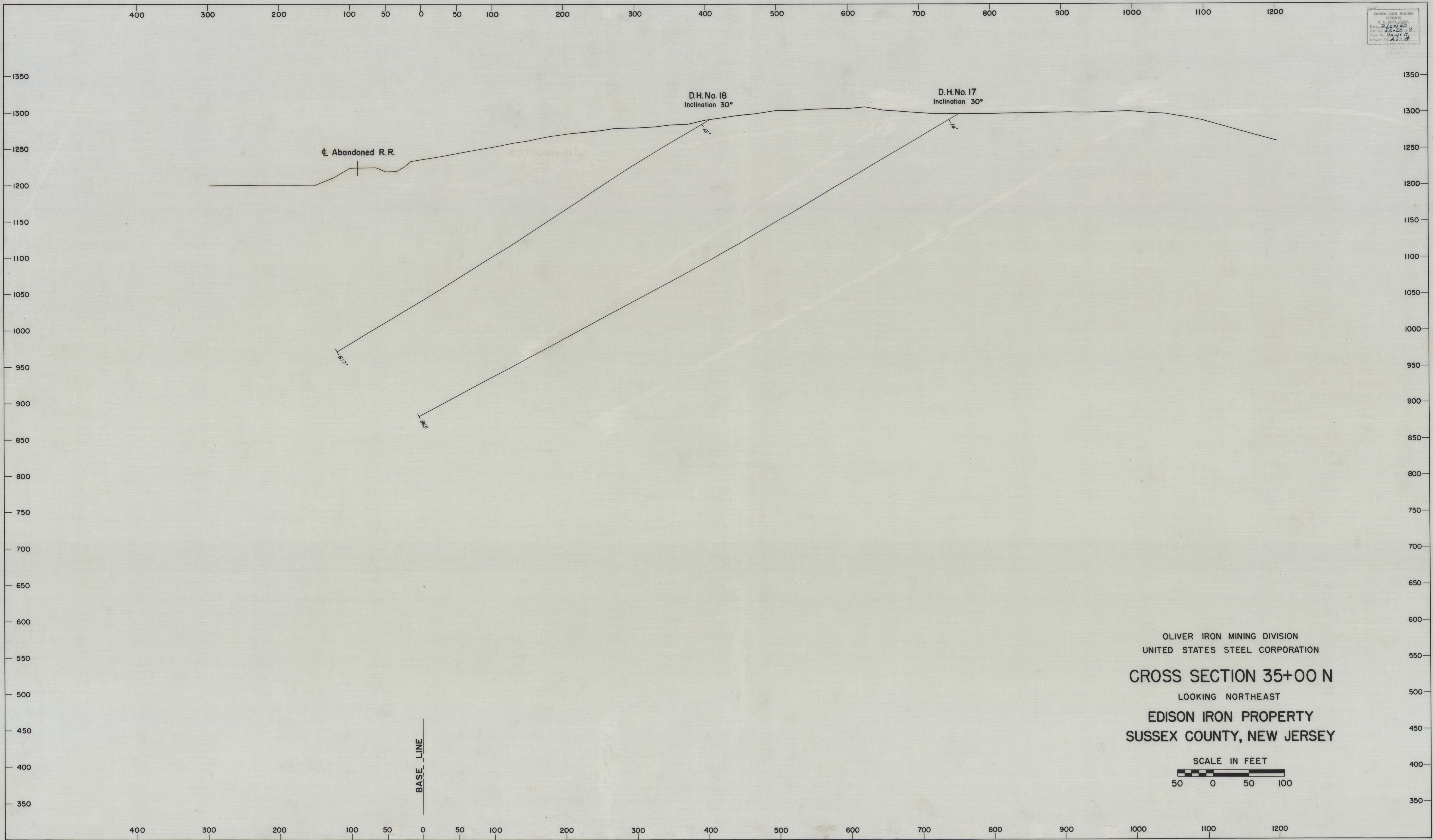

OLIVER IRON MINING DIVISION  
UNITED STATES STEEL CORPORATION  
**CROSS SECTION 35+00 N**  
LOOKING NORTHEAST  
EDISON IRON PROPERTY  
SUSSEX COUNTY, NEW JERSEY

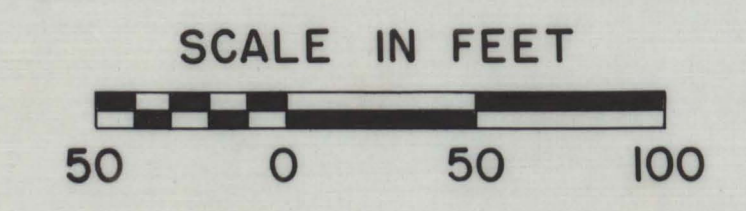

OLIVER IRON MINING DIVISION  
UNITED STATES STEEL CORPORATION  
Date: 5/20/59  
File No. 52-40-3  
Case No. 1-1-15  
Drawing No. A.I.-7

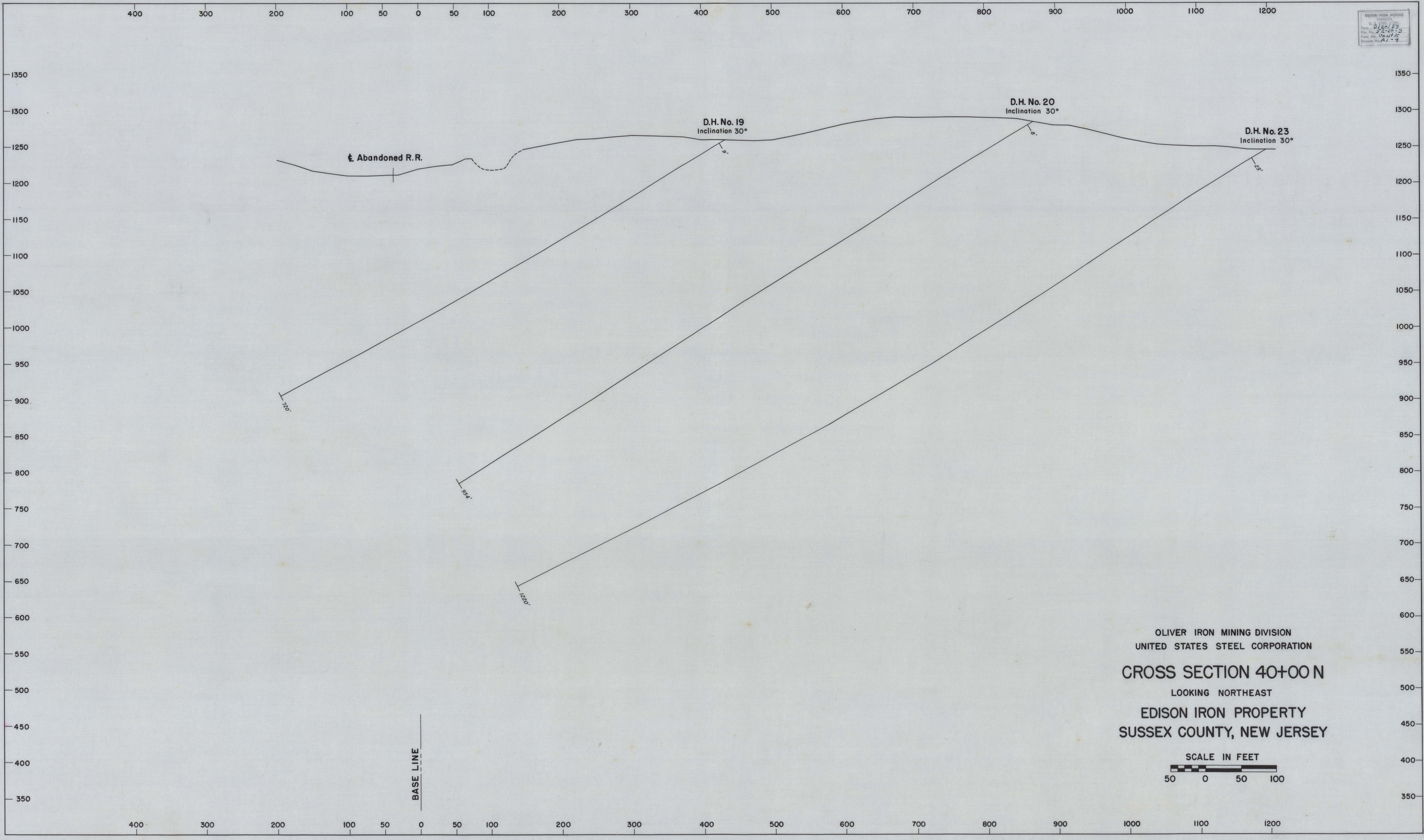

Abandoned R.R.

D.H. No. 19  
Inclination 30°

D.H. No. 20  
Inclination 30°

D.H. No. 23  
Inclination 30°

BASE LINE

OLIVER IRON MINING DIVISION  
UNITED STATES STEEL CORPORATION  
**CROSS SECTION 40+00 N**  
LOOKING NORTHEAST  
EDISON IRON PROPERTY  
SUSSEX COUNTY, NEW JERSEY

SCALE IN FEET  
50 0 50 100

OLIVER IRON MINING DIVISION  
UNITED STATES STEEL CORPORATION  
Date: 3/22/53  
File No. 52-20-10  
Case No. 175  
Drawn by: A.L.C.

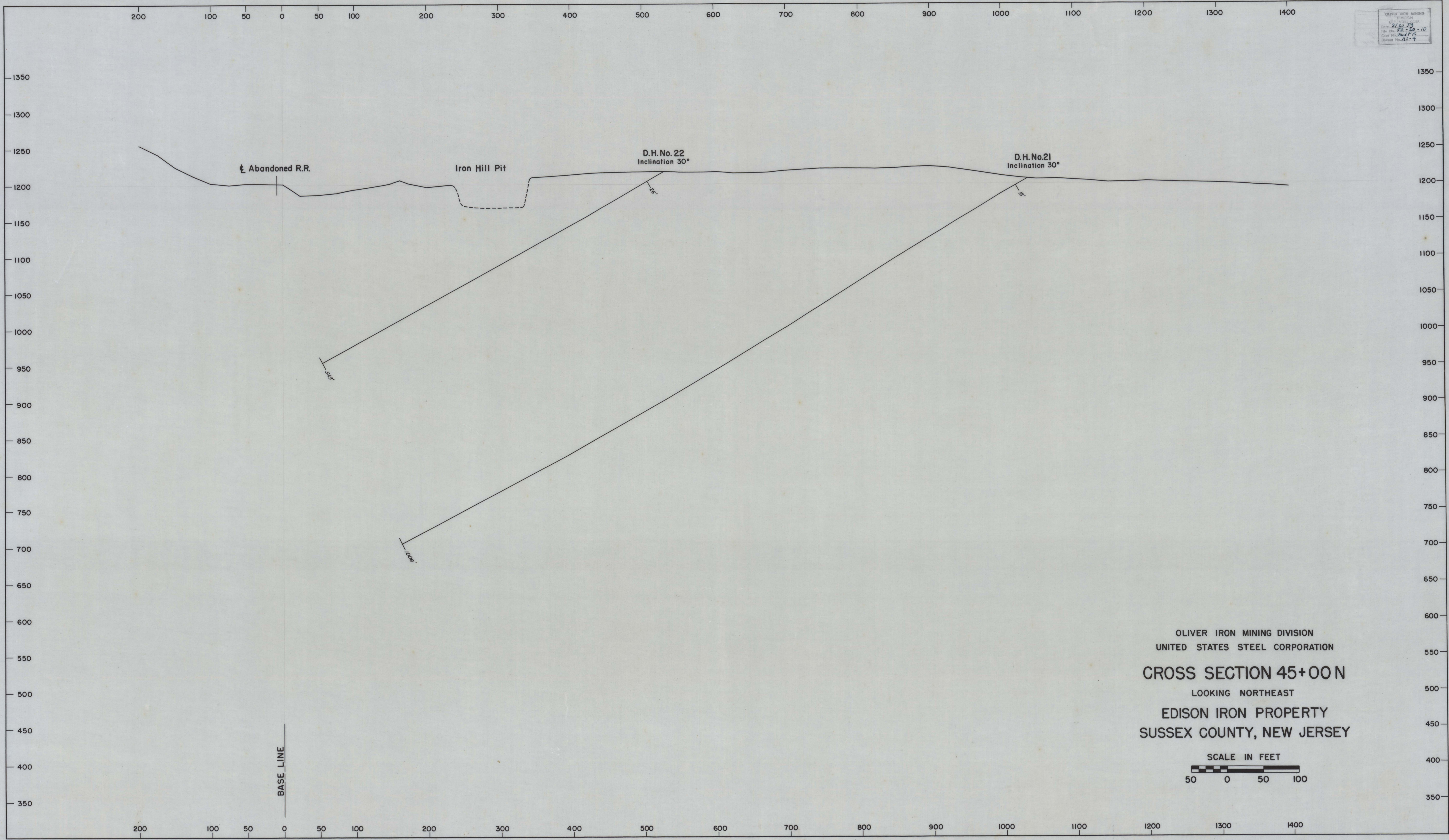

OLIVER IRON MINING DIVISION  
UNITED STATES STEEL CORPORATION  
**CROSS SECTION 45+00N**  
LOOKING NORTHEAST  
EDISON IRON PROPERTY  
SUSSEX COUNTY, NEW JERSEY

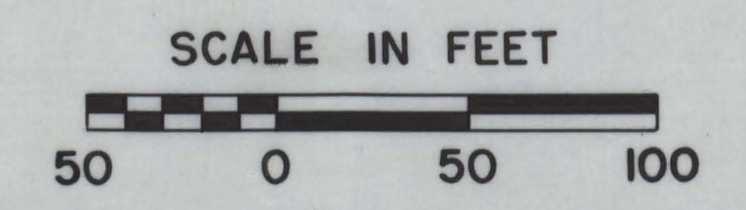

OLIVER IRON MINING DIVISION  
DRAWN BY: J. H. ...  
CHECKED BY: ...  
DATE: 11-28-35  
SCALE: 1" = 100'  
PROJECT: ...

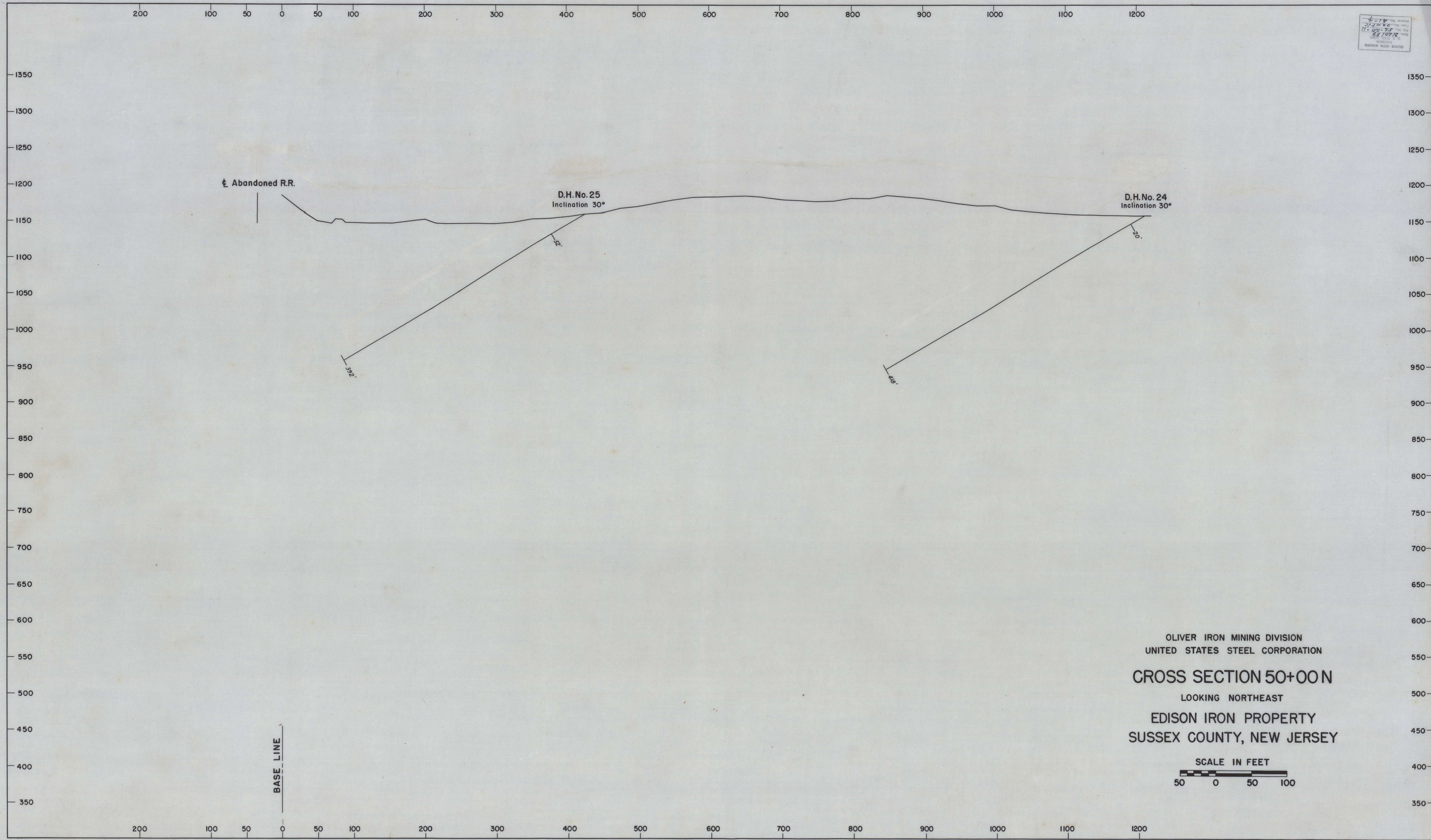

OLIVER IRON MINING DIVISION  
UNITED STATES STEEL CORPORATION  
**CROSS SECTION 50+00 N**  
LOOKING NORTHEAST  
EDISON IRON PROPERTY  
SUSSEX COUNTY, NEW JERSEY

