

- - - - - LANDFILL CAPPED AREA
- - - - - HIGHLANDS OPEN WATER BUFFER
- ▨ - PROPOSED SOLAR PANEL UNIT

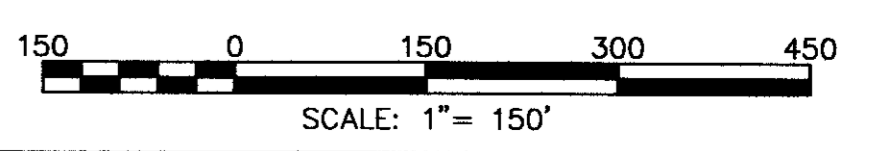

DRAWN BY:		DESIGNED BY:		APPROVED BY:		REVISIONS	
DATE:		DATE:		DATE:		NO.	DESCRIPTION

MATRIXNEWORLD
Enabling Progress

120 Eagle Rock Ave., Suite 207
East Hanover, New Jersey 07836
WBE / DBE / SBE
NEW JERSEY CERTIFICATE OF AUTHORIZATION No. 24GA2782300

Tel: 973-240-1800
Fax: 973-240-1818
www.matrixnewworld.com

**FORMER FENIMORE SANITARY LANDFILL
BLOCK 7404, LOT 1
ROXBURY TOWNSHIP
MORRIS COUNTY, NEW JERSEY
REDEVELOPMENT PLAN**

PROJECT NUMBER:
07-172E

SCALE:

RD-1

© MATRIXNEWORLD 2/2007/07-172E Fenimore Landfill Redevelopment Plan 172E Drawings/Client/Photos/Shared/Client/Plan/Redevelopment/Plan/07-172E.dwg

LEGEND

	HIGHLANDS OPEN WATER BOUNDARY AS DELINEATED BY MATRIX NEW WORLD ENGINEERING
	PROPOSED HIGHLANDS OPEN WATER BUFFER
	LIMIT OF LANDFILL
	LIMIT OF PROPOSED BROWNFIELD DESIGNATION
	STREAM CENTER LINE
	HIGHLANDS OPEN WATER TO BE FILLED TO REMEDIATE LANDFILL

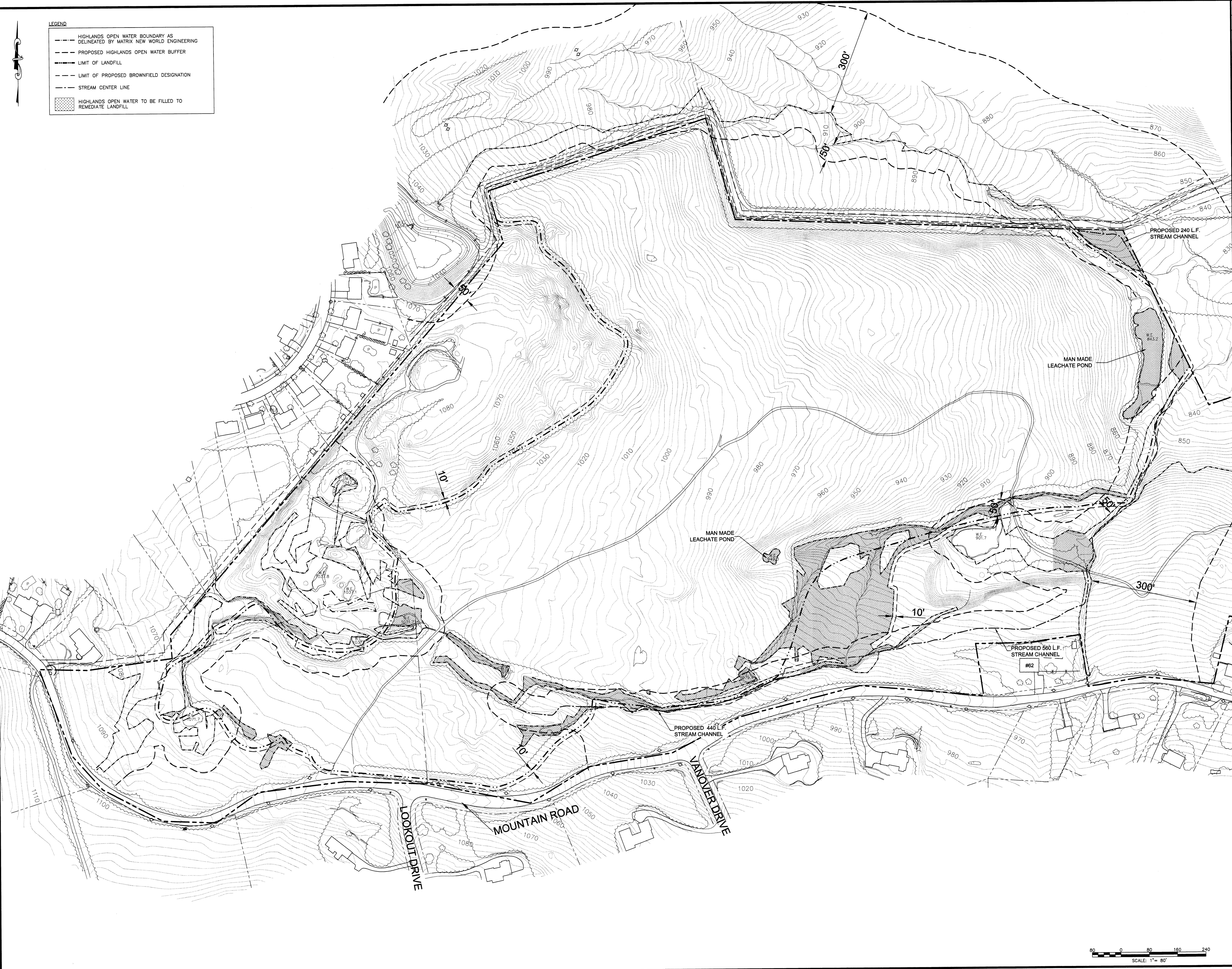

NO.	DESCRIPTION	DATE	BY	APR.

DESIGNED BY: JTE
 CHECKED BY: JTE
 DATE: 7/27/11
 DATE: 7/27/11
 DATE: 7/27/11
 DATE: 7/27/11

WILLIAM T. MANNING, P.L.S.
 NEW JERSEY PROFESSIONAL ENGINEER
 LICENSE NO. 0E 0389

DATE: 7/28/11

MATRIXNEWORLD
 Enabling Progress

120 Eagle Rock Ave., Suite 207
 East Hanover, New Jersey 07936
 Tel: 973-240-1800
 Fax: 973-240-1818
 www.matrixnewworld.com
 NEW JERSEY CERTIFICATE OF AUTHORIZATION NO. 34032702330

**FORMER FENIMORE SANITARY LANDFILL
 BLOCK 7404, LOT 1
 ROXBURY TOWNSHIP
 MORRIS COUNTY, NEW JERSEY**

TRACK 1 BROWNFIELD DESIGNATION PLAN

PROJECT NUMBER:
 07-172E

SCALE: AS NOTED

BD-1

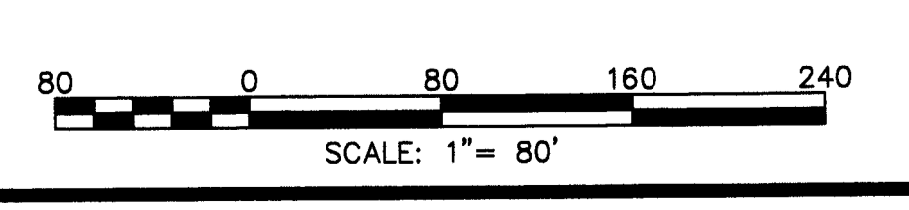

© MATRIXNEWORLD P. 1200707-172E Fenimore Landfill Roxbury 07-172E Drawing of Landfill for Sheets Brownfield Designation Plan Brownfield Designation Plan.dwg