

STATE OF NEW JERSEY
HIGHWAY DEPARTMENT

PLANS OF
ROUTE 46 (1953) SECTION 1
Dunnfield to Columbia
 GRADING
 Pahaquarry and Knowlton Townships
 Warren County

Scales as Indicated

May 1952

INDEX OF SHEETS	
1	KEY MAP
2	ESTIMATE OF QUANTITIES
3	DISTRIBUTION SHEET
4	TYPICAL SECTIONS
5-19	10 PLAN SHEETS
20-23	19-22 LAYOUT & TIE SHEETS
24-116	23-112 X-SECTIONS
117	115 EARTHWORK CHART
118-124	114-120 CONSTRUCTION DETAILS
125-127	121-123 BRIDGE PLANS
128-131	124-127 RETAINING WALL

As Built

Control Section 2114

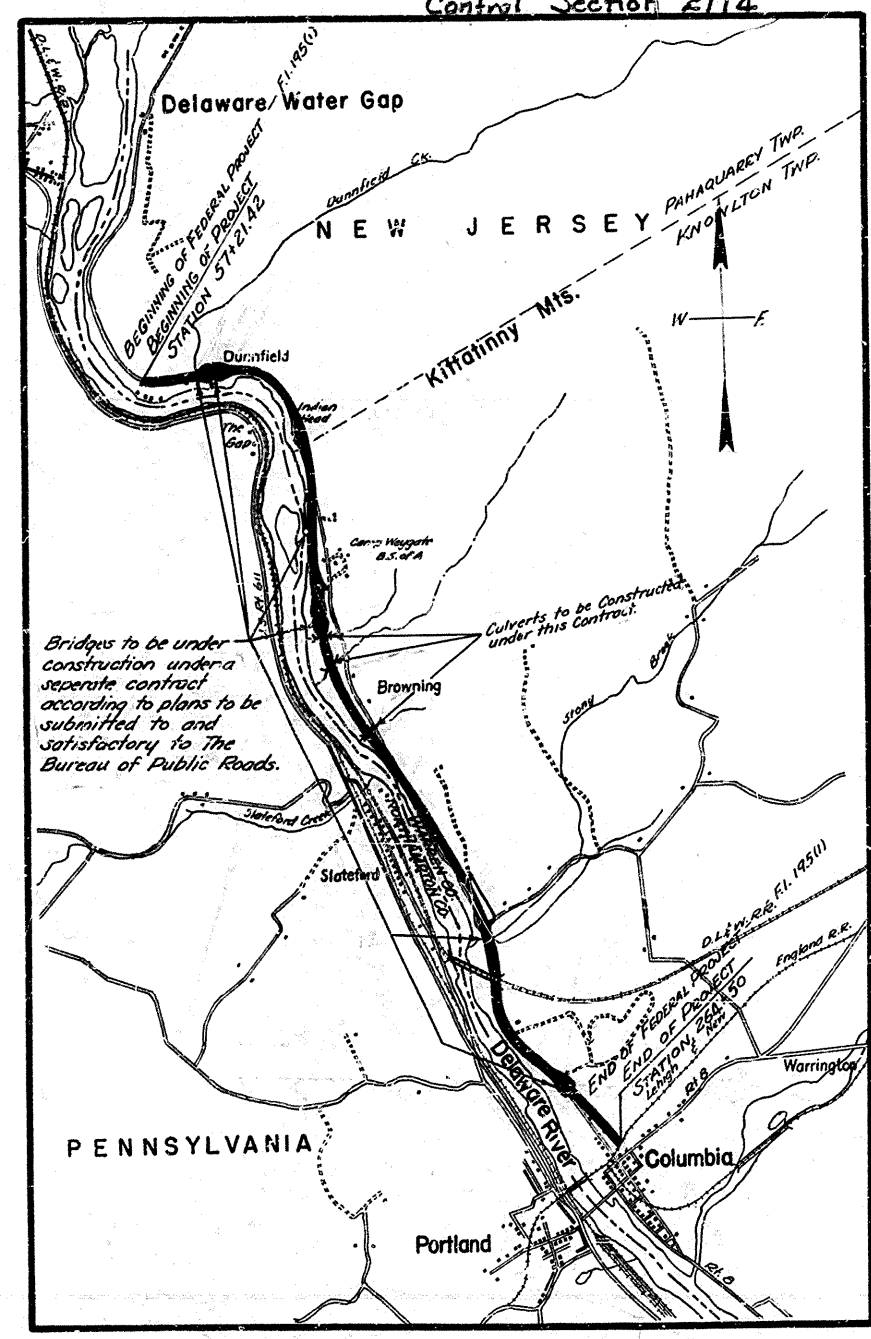

UTILITIES
NEW JERSEY POWER & LIGHT CO. DOVER, NEW JERSEY
BELL TELEPHONE CO. OF PENNSYLVANIA 831 ADAM AVENUE, SCRANTON, PA.
BLUE MOUNTAIN TELEPHONE & TELEGRAPH CO. MAIN & WASHINGTON STS., BANGOR, PA.
DELAWARE, LACKAWANNA & WESTERN RAILROAD HOBOKEN, NEW JERSEY

As Built Data Compiled By *[Signature]*
 Senior Eng. Highway

Submitted by *[Signature]* May 23, 1952
 Director and Chief Bridge Engineer Date

Submitted by *[Signature]* 5-20-52
 Director and Chief Road Engineer Date

Approved by *[Signature]* 5-21-52
 State Highway Engineer Date

Approved by *[Signature]* 5-26-52
 State Highway Commissioner Date

LAYOUT & KEY MAP

SCALE - 1" = 1/2 MILE

LENGTH OF PROJECT - 20728.58 Lin. Ft. - 3.926 Miles

STANDARD HIGHWAY SPECIFICATIONS OF 1941 TO GOVERN

LENGTH OF FEDERAL PROJECT - 20728.58 Lin. Ft. - 3.926 Miles

DEPARTMENT OF COMMERCE
 BUREAU OF PUBLIC ROADS

RECOMMENDED FOR APPROVAL

DISTRICT ENGINEER DATE

APPROVED

DIVISION ENGINEER DATE

1
 127
 13

23-11

2114 001 131

TYPICAL SECTIONS SCALE 1" = 6'

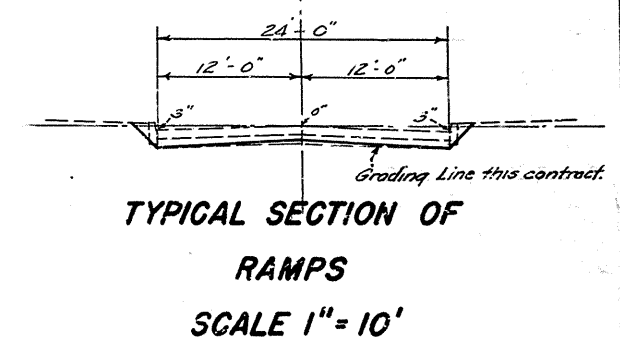
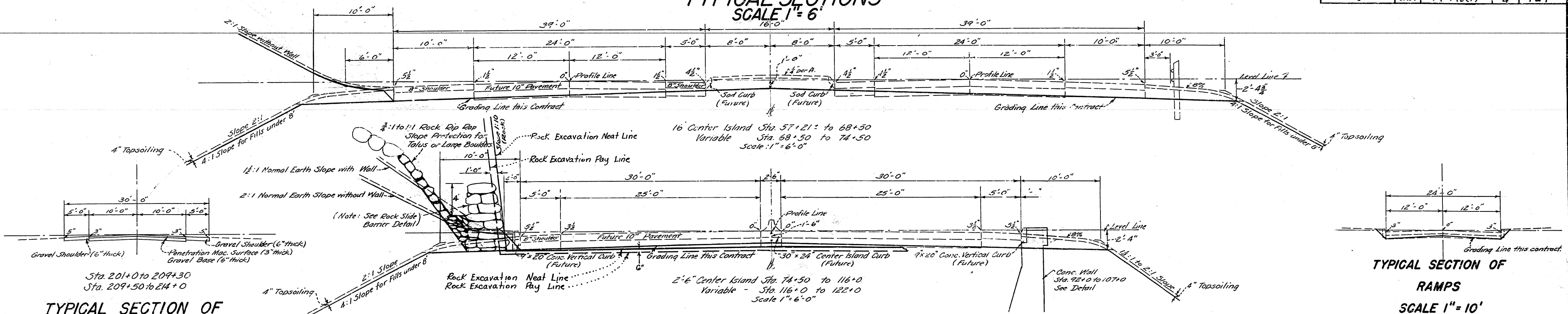

Note: All cut slopes, except rock, to be topped. Fill slopes to be topped as far as striped material is available at locations as directed by engineer.

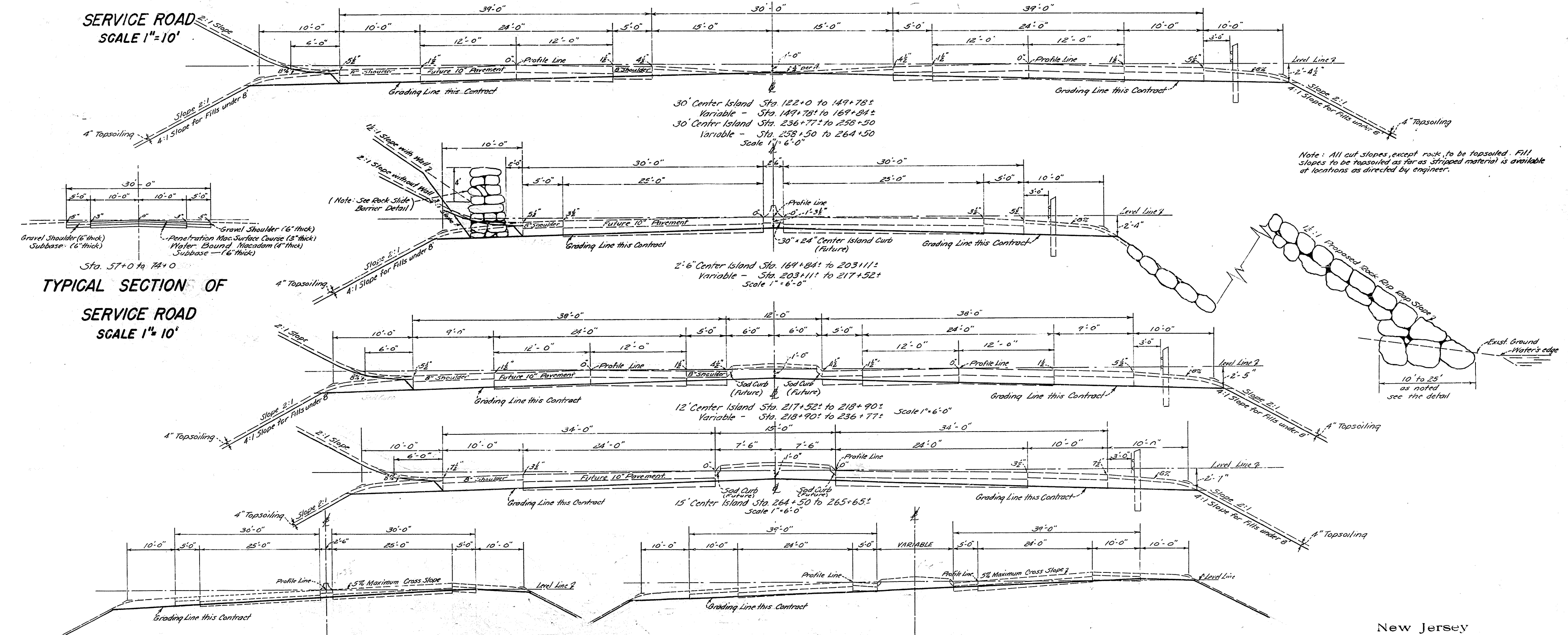

New Jersey
State Highway Department
TYPICAL SECTIONS
ROUTE 46 (1953) SECTION 1
Dunfield to Columbia
GRADING
Scales as Indicated

2114 004 131

PLAN SCALE
1" = 50'

CHARLES C. WORTHINGTON PAHAQUARRY TOWNSHIP KNOWLTON TOWNSHIP

GEORGE F. HELICK, ET. ALS, TRUSTEES
BOY SCOUTS OF AMERICA

GEORGE F. HELICK, ET. ALS, TRUSTEES
BOY SCOUTS OF AMERICA

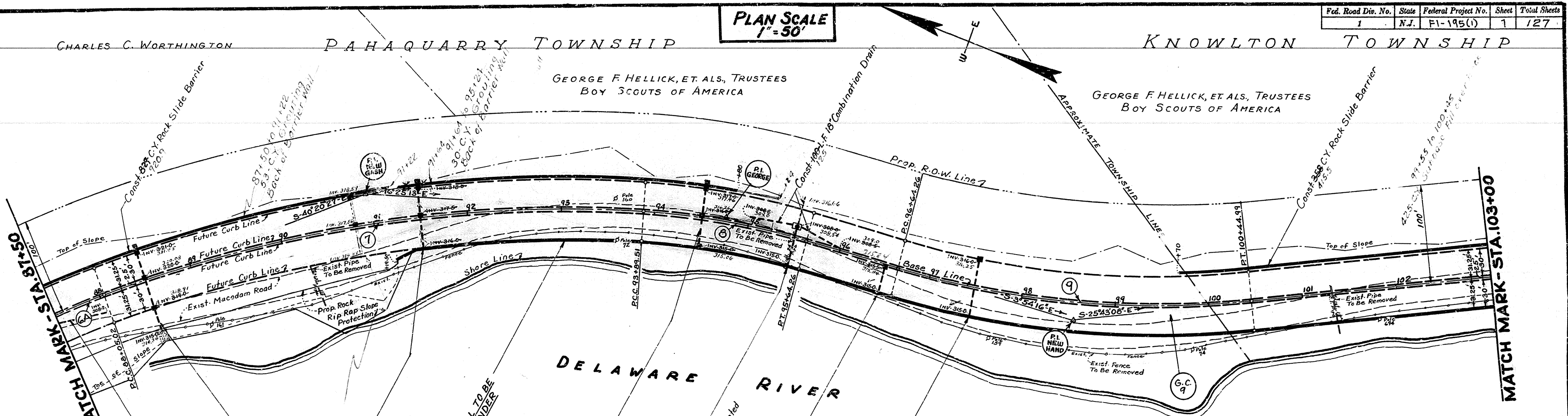

TO BE CONSTRUCTED		
	CONTRACT QUANTITY	AS BUILT QUANTITY
18" COMBINATION DRAIN	150 L.F.	175
18" REINF. CONC. CULVERT PIPE	274 L.F.	317
36" x 22" CORR. METAL PIPE ARCH, BIT COATED	40 L.F.	40
SPECIAL MANHOLE	1 UNIT	1
INLETS TYPE A	4 UNITS	5
INLETS TYPE B	5 UNITS	5
GROUTING	2 C.Y.	157
ROCK SLIDE BARRIER	1187 C.Y.	1336.4
12" CORR. METAL CULVERT PIPE, BIT COATED	27 L.F.	27
GROUTED RUBBLE STONE GUTTER	95	0
INLET TYPE A FRAME & GRATE	1 UNIT	1
SUBBASE	C.Y.	425

BENCH MARK
G.C. 9 - Elev. 313.542 - Top of R.R. spike in rock wall of Gap 38.9' N.E. of pole 74, 2.5' above surface of ground.

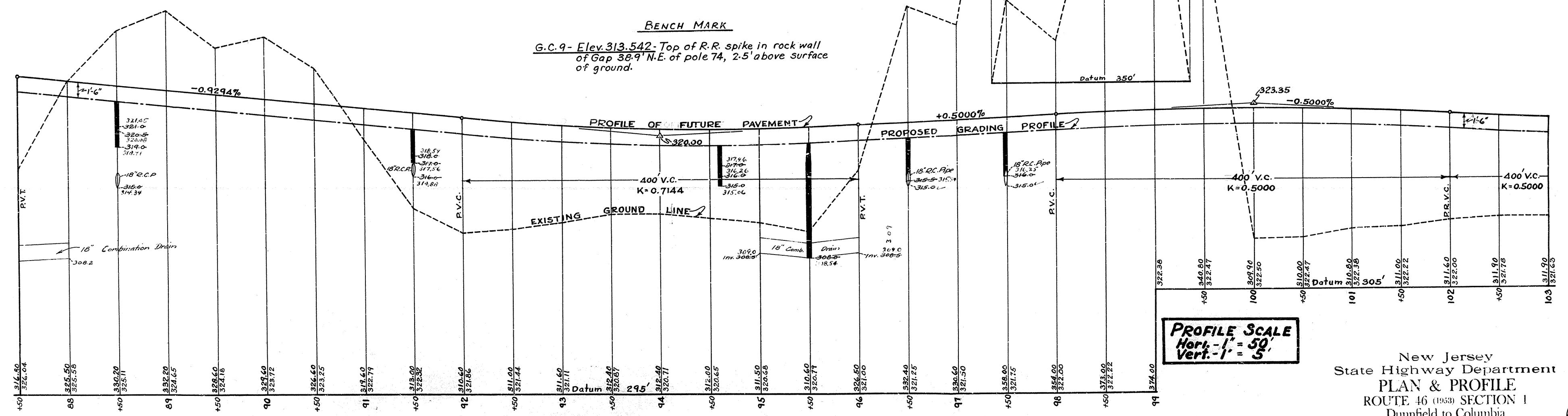

PROFILE SCALE
Horiz. - 1" = 50'
Vert. - 1" = 5'

New Jersey State Highway Department
PLAN & PROFILE
ROUTE 46 (1953) SECTION 1
Dunfield to Columbia
GRADING
Scale as Indicated

See X-Section Sheets # 35 to 41

2114 007 131