

pen table= \\njdotprjws\vsystem\NJDOT\Projects\NJDOTEng\Plot\TBLs\Roadway\basic.tbl
 scale=30.000000:1.000000
 date=17-DEC-2007 09:41
 ID=TPXBHAY

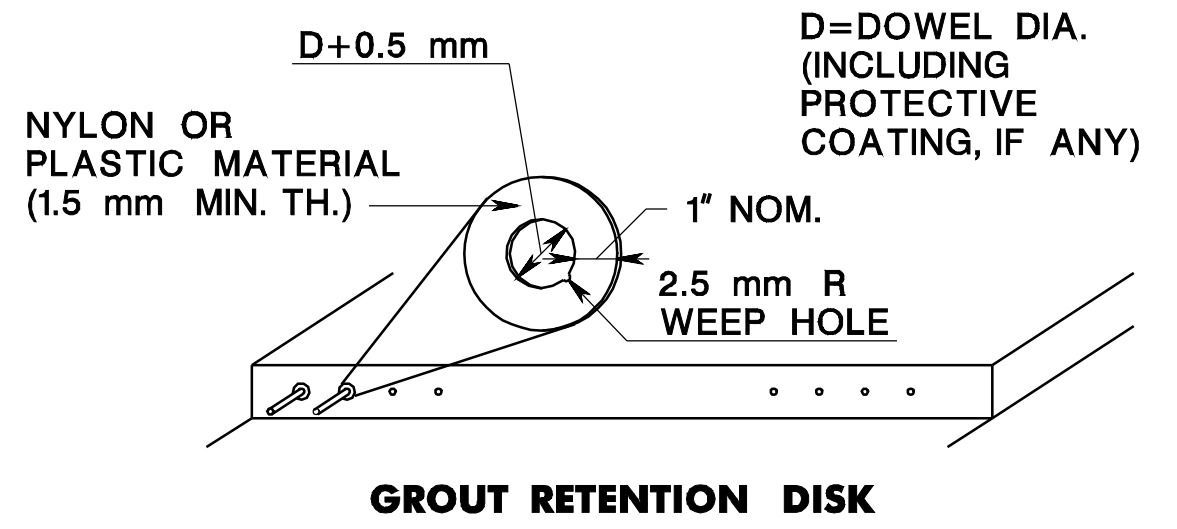

NOTES:

1. SAWCUTS SHALL BE MADE PERPENDICULAR TO BASELINE.
2. INITIAL SAWCUT IS NOT REQUIRED FOR BUTT JOINTS.
3. A MINIMUM OF 3" CONCRETE COVER IS REQUIRED OVER REINFORCEMENT STEEL MAT.
4. SPACE CONTRACTION JOINTS AND CONTRACTION/BUTT JOINTS EQUIDISTANT AND NOT MORE THAN 20' APART.

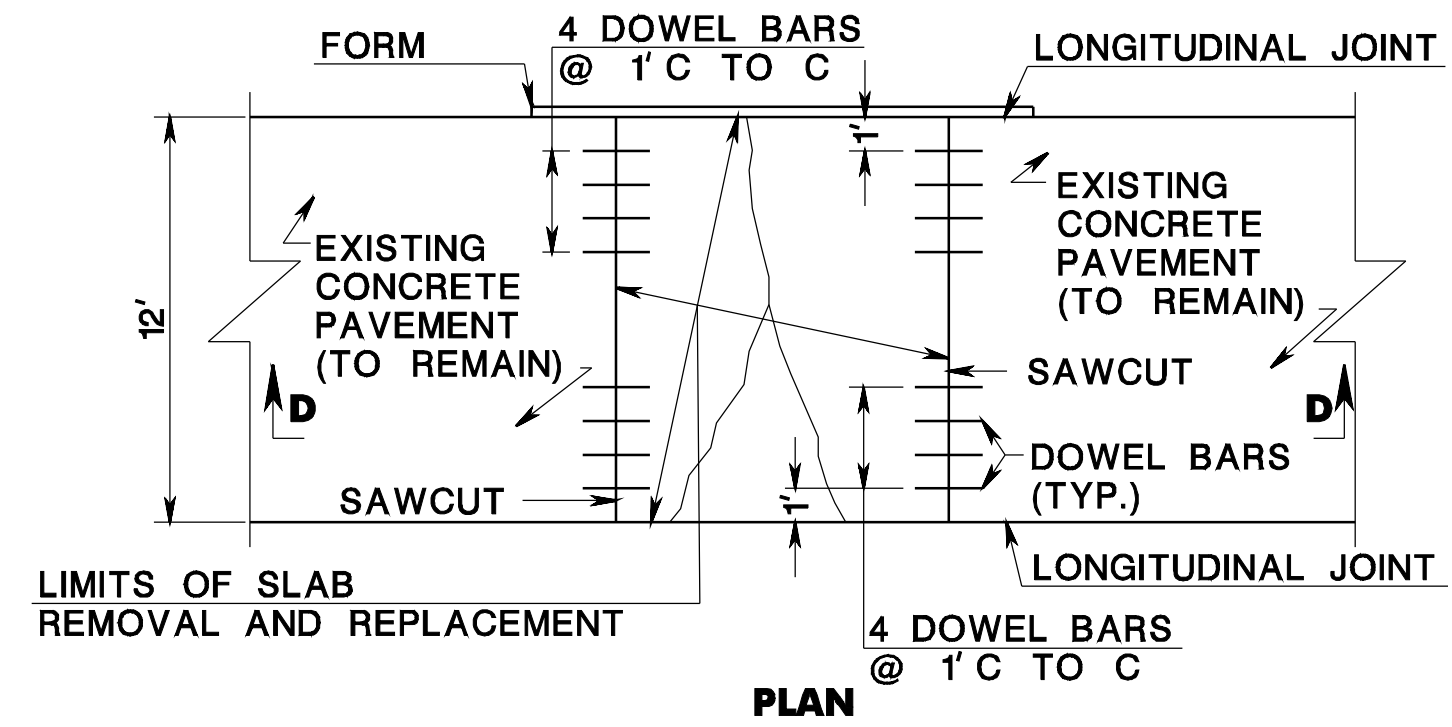
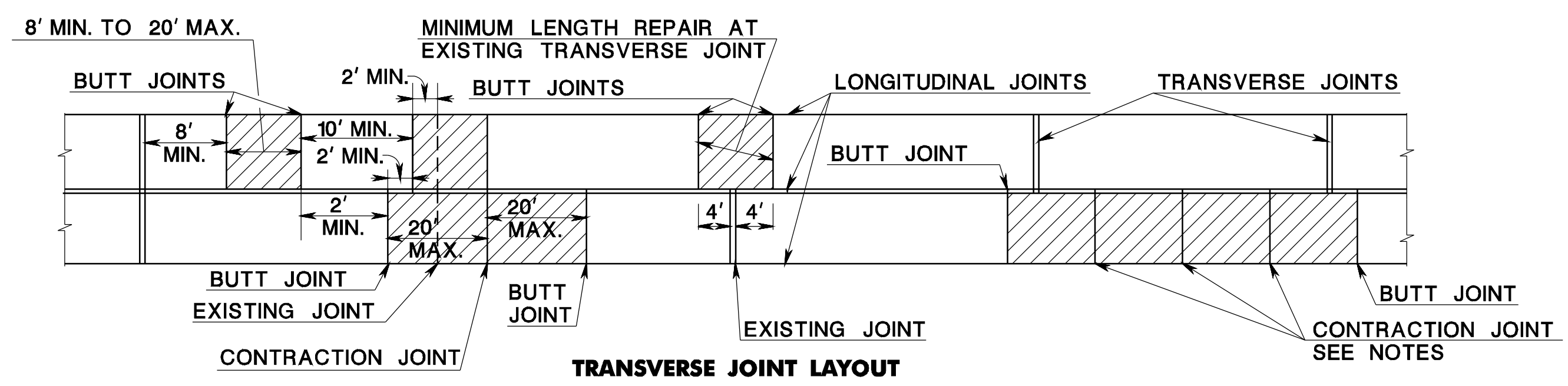
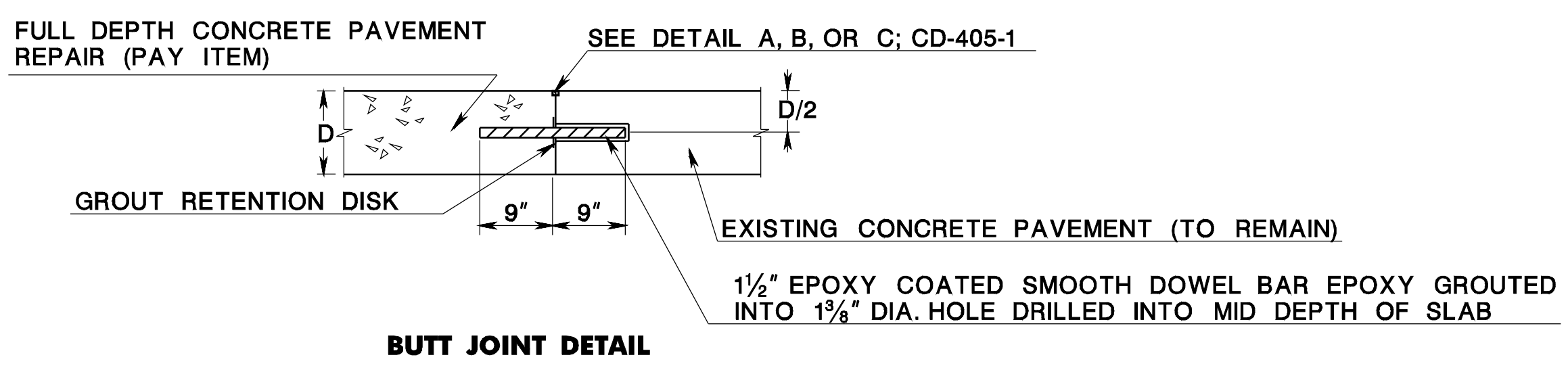
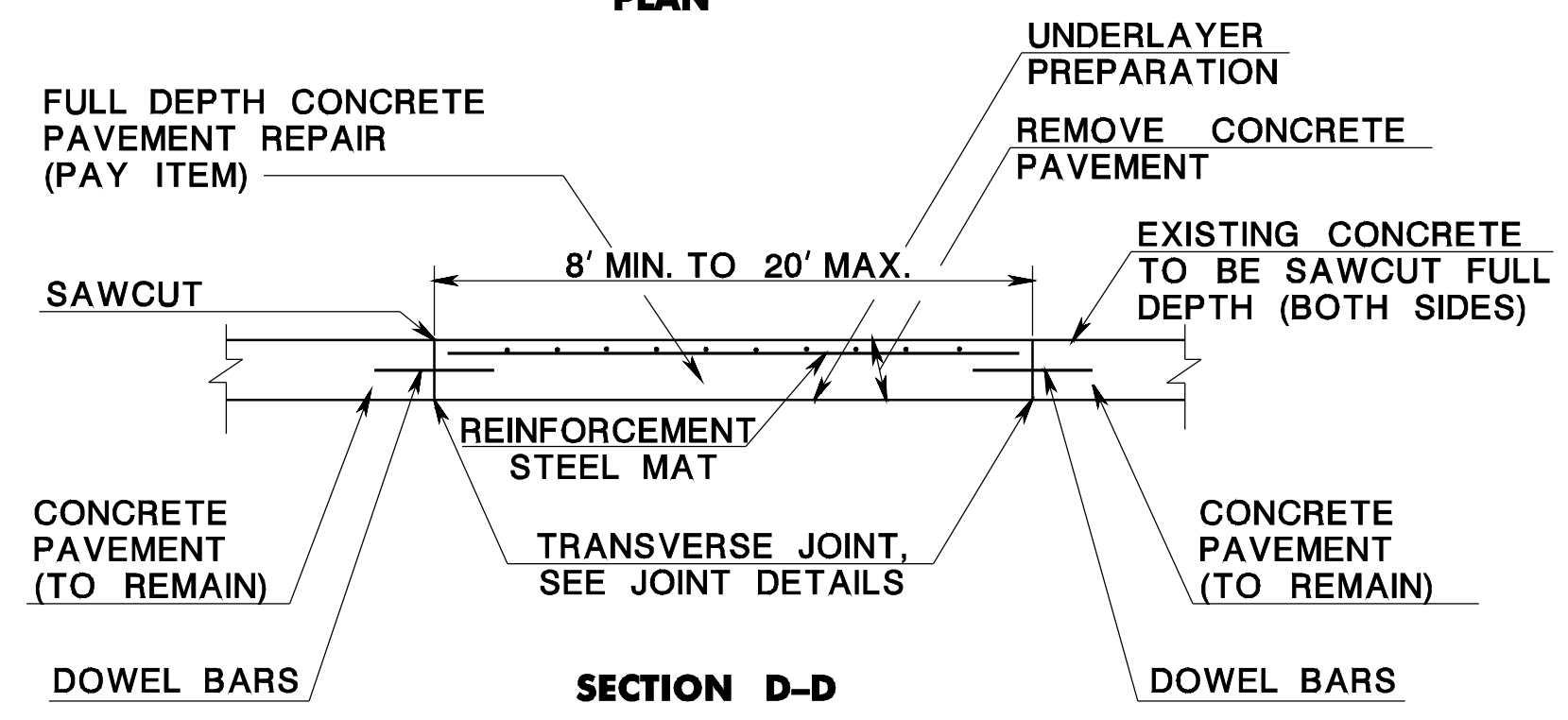

FULL DEPTH CONCRETE PAVEMENT REPAIR

FULL DEPTH CONCRETE PAVEMENT REPAIR

N.T.S.

CD-453-1
 NEW JERSEY DEPARTMENT OF TRANSPORTATION

CONSTRUCTION DETAILS

CD-453-1.1