

pen table= \\njdotprjws\vsystem\NJDOTWS\Projects\NJDOTEng\Plot\TBLs\Roadway\basic.tbl
 scale= 30.000000;1.000000
 date= 17-DEC-2007 09:57
 ID= TPXBHAY

BDC07D-01- ORIGINAL SHEET

LEGEND

"W" IS THE WIDTH OF LANE CLOSURE IN FEET

"L" IS THE LENGTH OF TAPER

"#" IS NUMBER OF CONES IN TAPER AT 40' SPACING

LENGTH OF TAPER CHART FOR MOVING OPERATIONS

W	25 M.P.H.		30 M.P.H.		35 M.P.H.		40 M.P.H.		45 M.P.H.		50 M.P.H.		55 M.P.H.	
	L	#	L	#	L	#	L	#	L	#	L	#	L	#
1	10	2	15	2	20	2	30	2	45	3	50	3	55	3
2	25	2	30	2	45	3	55	3	90	4	100	4	110	4
3	35	2	45	3	65	3	80	3	135	5	150	5	165	5
4	45	3	60	3	85	4	110	4	180	6	200	6	220	7
5	55	3	75	3	105	4	135	5	225	7	250	7	275	8
6	65	3	90	4	125	5	160	5	270	8	300	9	330	9
10	105	4	150	5	205	6	270	8	450	13	500	14	550	15
11	115	4	165	5	225	7	295	9	495	14	550	15	605	16
12	125	5	180	6	245	7	320	9	540	15	600	16	660	18

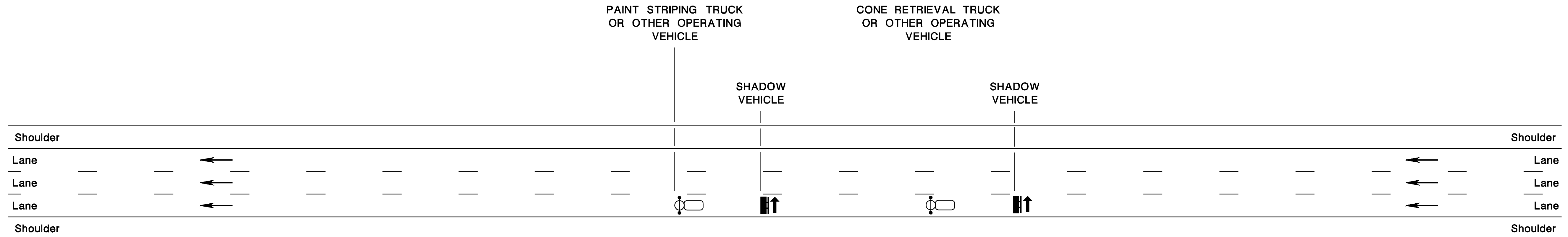

MULTI-LANE ROAD MOVING OPERATION

NOTE:

SHADOW VEHICLE SHALL MAINTAIN A DISTANCE OF 70 FEET MINIMUM TO A MAXIMUM OF 150 FEET BEHIND THE OPERATING VEHICLE.

N.T.S.

TCD-22

NEW JERSEY DEPARTMENT OF TRANSPORTATION

TRAFFIC CONTROL DETAILS