

SECTION OF BRIDGE APPROACH SLABS

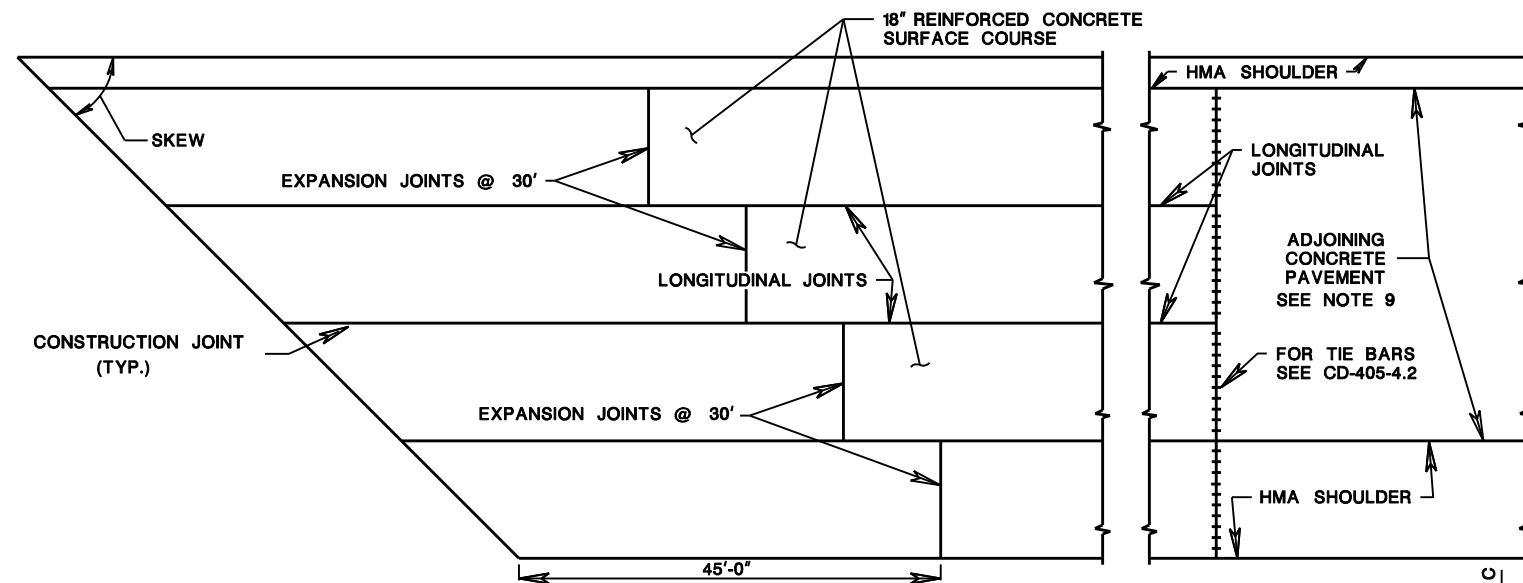

PLAN OF BRIDGE APPROACH SLABS

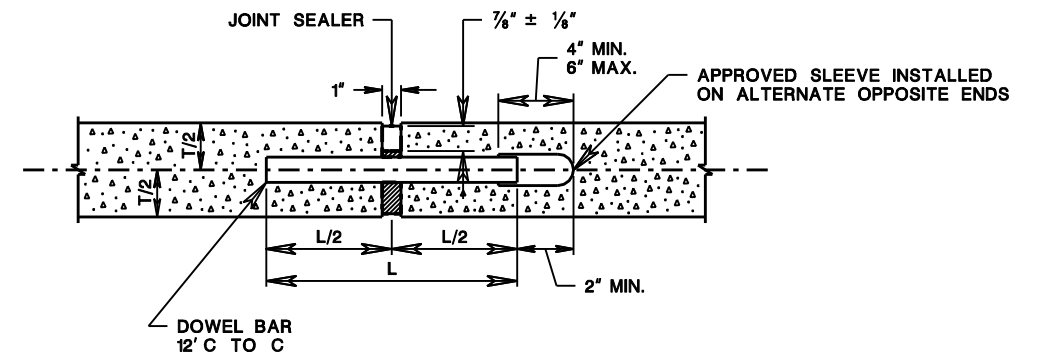
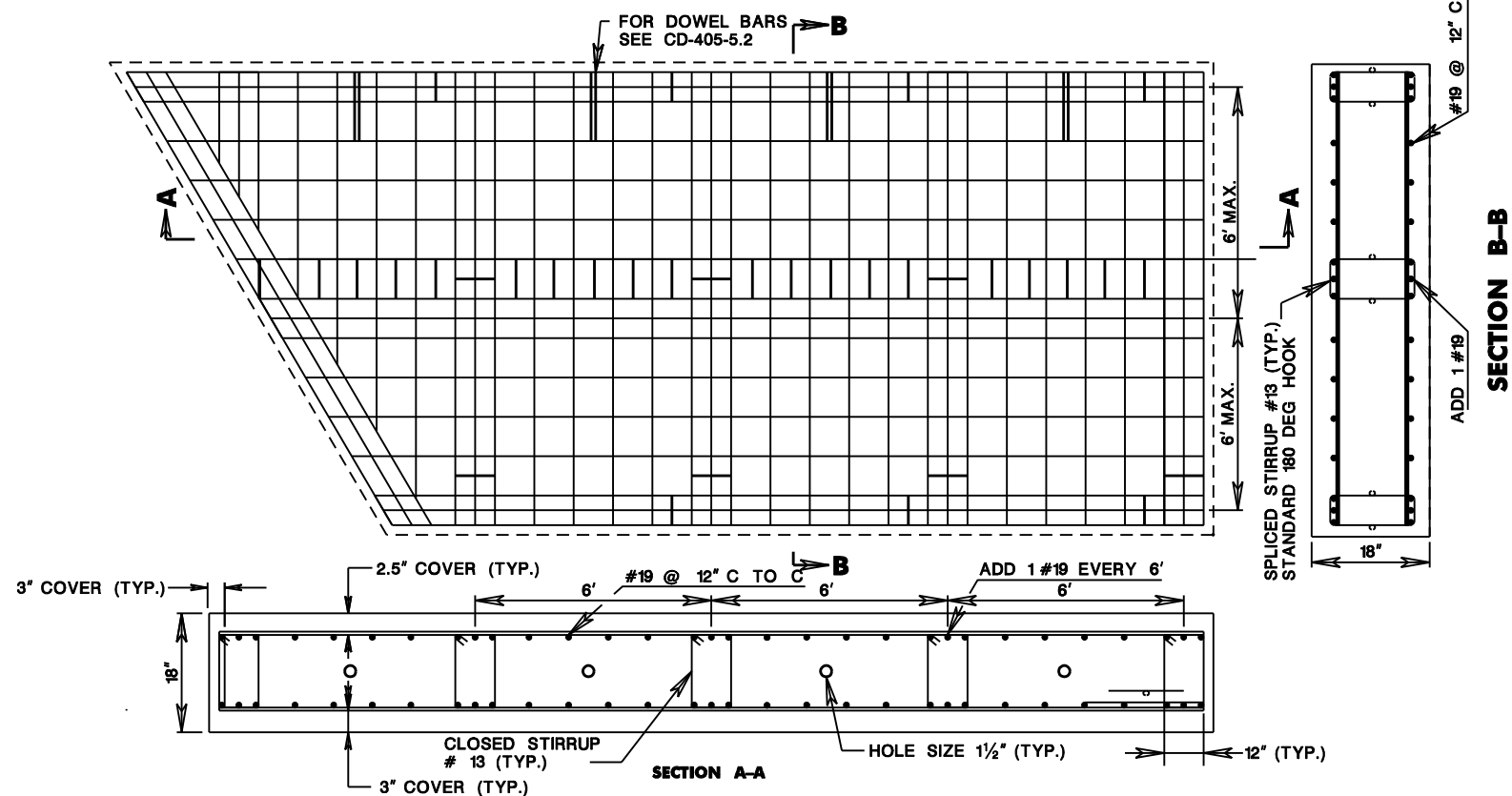

EXPANSION JOINT DETAIL

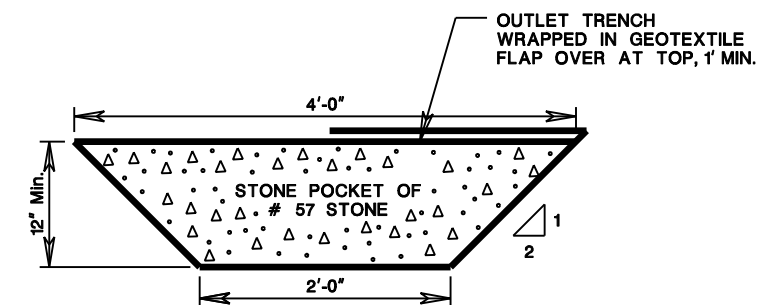

SUBBASE OUTLET DRAIN

NOTES:

1. EXTRA BAR FOR EMBEDDED BEAM (EB) PATTERN TO BE SPACED NOT MORE THAN 6 FEET ON CENTERS.
2. INSTALL REBAR CHAIRS TO SEPARATE TOP AND BOTTOM MATS (AS SHOWN).
3. WIDER/LONGER SLABS MAY BE CONSTRUCTED PROVIDED THE C TO C SPACING OF EB EXTRA REBAR IS NOT MORE THAN 6 FEET.
4. ALTERNATE DESIGN WITH STIRRUPS: CLOSED STIRRUPS SUBSTITUTED FOR REBAR CHAIRS. SPACING NOT MORE THAN 3 FEET C TO C. STIRRUP MUST ENCLOSE TOP 3 AND BOTTOM 3 BARS.
5. ALL REINFORCEMENT TO BE CORROSION PROTECTED.
6. CONSTRUCT APPROACH SLABS WITH CLASS A CONCRETE. HPC MAY BE USED FOR THE APPROACH SLAB CONSTRUCTION. APPROPRIATE PAY ITEM AS SPECIFIED IN THE STANDARD SPECIFICATION SHOULD BE USED. BASIS OF PAYMENT SHALL BE CUBIC YARDS.
7. THE APPROACH SLAB SHALL BE SAWCUT GROOVED FINISHED. THE METHODS USED SHALL BE ACCORDING TO THE REQUIREMENTS SPECIFIED IN THE NJDOT STANDARD SPECIFICATIONS FOR CONCRETE DECK SLABS.
8. FOR STIRRUP DETAILS SEE BCD-10.
9. PAVEMENT SLABS SHALL BE 23'-7" LONG WITH STANDARD REINFORCEMENT. SLAB JOINTS SHALL BE DOWELLED TOGETHER. JOINT FILLER SHALL BE PREFORMED BITUMINOUS FIBER, 1" THICK.

NOTES:

REINFORCING BARS ARE IN METRIC UNITS.
HMA = HOT MIX ASPHALT
HPC = HIGH PERFORMANCE CONCRETE

BCD-11

NEW JERSEY DEPARTMENT OF TRANSPORTATION

**BRIDGE APPROACH SLABS
ADJOINING
CONCRETE PAVEMENT**

129B
129