

Radon and Smoking: A Risky Combination

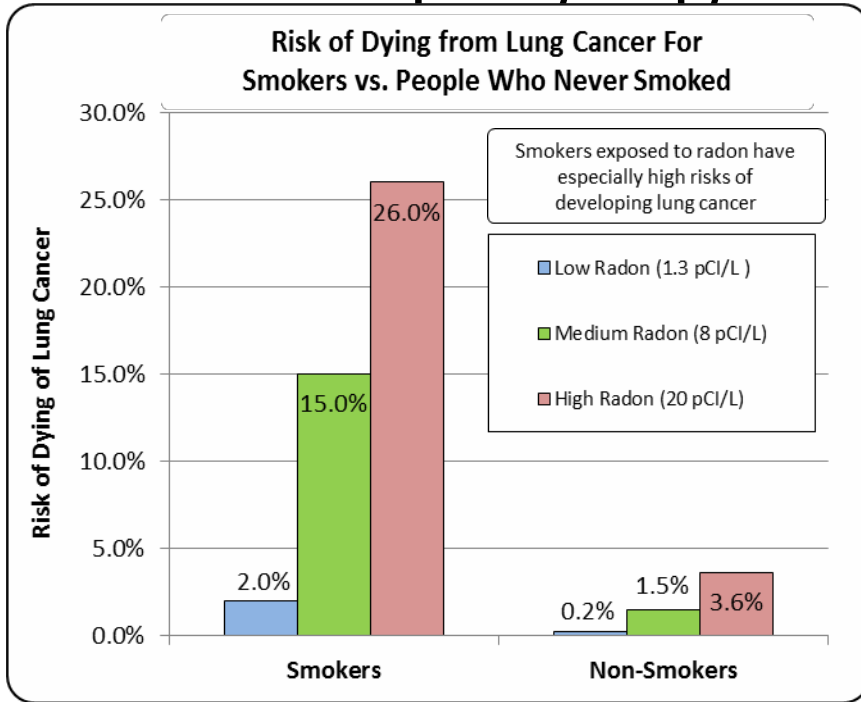

Radon & Smoking: Lung Cancer Risks Don't Add Up... They Multiply



Based on Lifetime risk from EPA Assessment of Risks from Radon in Homes (EPA 402-R-03-003)

*Source: US Environmental Protection Agency (EPA), *A Citizen's Guide to Radon*, 2009.

If you smoke and your home has high levels of radon, your risk of getting lung cancer is especially high.*

The EPA estimates that 86% of radon-related lung cancer deaths occur among current or former smokers.*

The risk of lung cancer to non-smokers increases drastically as radon levels in the home increase.

*Source: US Environmental Protection Agency (EPA), *A Citizen's Guide to Radon*, 2009.

Take Action

Lung cancer due to smoking and radon *can* be prevented.

- ✓ Quitting smoking is the best way to reduce your risk of lung cancer.
- ✓ Test your home for radon.

Lung Cancer: The #1 Cause of Cancer Death

Lung cancer kills more people in New Jersey than any other kind of cancer.

Nearly 90% of lung cancer cases are due to smoking. †

Radon is the leading cause of lung cancer among non-smokers. †

Each year, there are an estimated 566 radon related deaths among New Jersey residents. †

Cancer is the 2nd leading cause of death after heart disease in New Jersey.

†Source: US EPA. *EPA Assessment of Risks From Radon in Homes*. 2003.

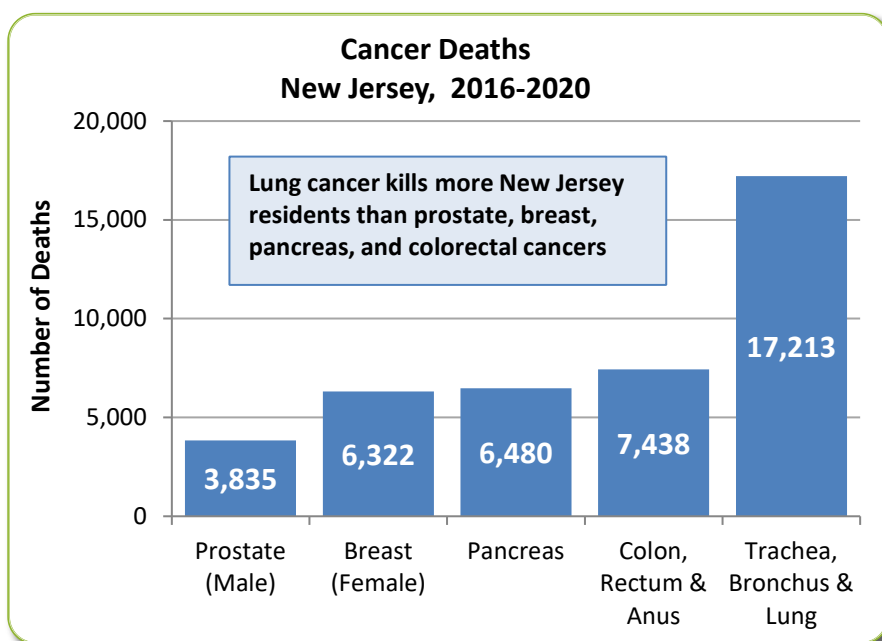

Radon and Smoking: A Risky Combination

Radon: A Silent Killer

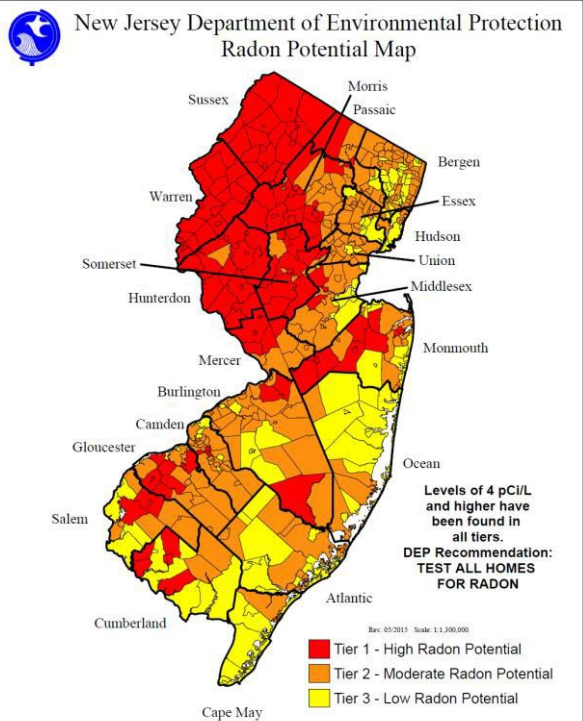

For information in New Jersey, call (800) 648-0394 or go to WWW.NJRADON.ORG

One in 6 New Jersey homes has elevated levels of radon *

*exceeds the EPA action level of 4pCi/L of air.

- 72% of New Jersey homes have never been tested for radon.
- Testing your home is the only way to know your home's radon level is high.
- All homes should be tested for radon.
- Radon problems can be fixed by installing a radon mitigation system.

What is radon?

Radon is a naturally occurring, cancer-causing radioactive gas with no color, odor or taste.

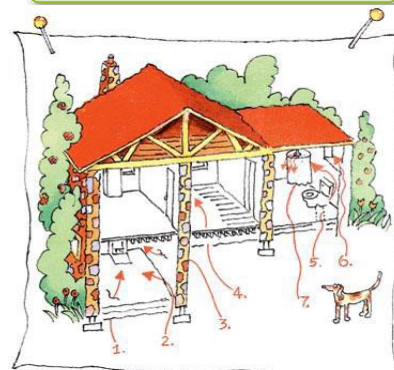

Radon moves from the soil and into your home through cracks and openings in the foundation.

Lung Cancer Risk by Radon Level and Smoking

Radon Level (pCi/L)	Odds for non-smokers* of developing lung cancer <i>due to radon</i> if exposed to this level over a lifetime	Odds for smokers* of developing lung cancer <i>due to radon</i> if exposed to this level over a lifetime**
20	1 in 27	1 in 5
8	1 in 68	1 in 13
4	1 in 135	1 in 26
2	1 in 270	1 in 52
0.4***	1 in 1,350	1 in 260

*Smokers are defined as individuals who have smoked at least 100 cigarettes in a lifetime; non-smokers have never smoked or smoked less than 100 cigarettes in a lifetime.

**In addition to the risk of lung cancer from smoking itself.

***Average outdoor radon concentration.

Source: US Environmental Protection Agency (EPA), *A Citizen's Guide to Radon*, 2009.

Resources

New Jersey Department of Environmental Protection

Information on radon in New Jersey can be found at: njradon.org/

A listing of radon testing and mitigation businesses in New Jersey can be found at: bit.ly/NJDEPCertRadonList or call: **1-800-648-0394**

New Jersey's Quitline offers free services to help you quit smoking.
njquitline.org/
1 866-NJSTOPS (657-8677)