

OVERSIZED DOCUMENT
SCANNED IN PARTS DUE TO SIZE

New Jersey State Archives
Early Land Records

WJ Loose Records : 1772 - West, John (OV-B) (42580) (PWESJ004)

TO: John West (John West's saw mill; Also owner of adjoining land)

SURVEY AND MAP. 104 acres. Between two branches of Little Egg Harbor River
called Nescacheage Creek and Machescatuason; On the South side of Goose Pond;
Cedar Swamp; Gloucester County

Surveyed for 104 acres after deductions for prior surveys

DATE: 13 Oct 1772

12/19/2023

1772 West, John

Goose Pond, Gloucester County

104 acres

October 13, 14+15, 1772

Survey (100)

42580

John West
104 Ave

[Decorative flourish]

July 3^o 1774
Robt & R. H. G.

Rec^d. 3^o July. 1774.

100
180
200
68
133
102.0
16.
101.0
57
70
75
17
25
30
1100.30
164
124



In pursuance of orders to me Directed bearing date the tenth day of May one thousand seven hundred and twenty one I have been directed by the Devises of Abraham Porter or his Assigns the Quantity of two hundred and fifty acres of land appropriated to him below the falls of Delaware River at Frankford by Virtue of a Conveyance from John Stone Deviser of the said Abraham Porter) unto John West of the same two hundred and fifty acres By Deed dated the twenty first Day of September 1772 I have surveyed for the said John West part thereof situate in the County of Gloucester in the Western Division of New Jersey a parcel of Land between Reseaching whereon John West's Saw Mill is erected) and Macheco two Branches of Little Egg Harbor River and is bounded as follows Beginning at a pine tree EW starting by the North side the N. V. Chesapeake Creek a Little below the Sawmill and about Six perches below a small gully and from thence Running N North twenty seven Degrees East forty two Chains to a pine tree T. G. Corner to a cedar tree surveyed to Thomas and David Clark standing by the South side the Goose ponds then along the South side thereof N North fifty nine Degrees thirty Minutes West fifty nine Chains seventy Links to a pine and over Don's mill site up to the edge S South fifty eight Degrees West twenty three to a pine tree EW then N North thirty four Degrees and thirty Minutes West fifteen Chains to a pine tree E. C. Corner to one hundred and thirty three acres surveyed to Elijah Clark then along the

17
49
1539
1026
11799
5899

17 J. Bishop's Plot 18
25 J. Bishop's Plot 18
50 J. Bishop's Plot 18
92
417
1190

Elijah Clark # 497
J. Bishop's Plot # 402
J. Bishop's Plot # 18
J. Bishop's Plot # 34
J. Bishop's Plot # 497
E. C. Corner
T. G. Corner

East 110 etc

Said Elijah Clark's line N North sixty five Degrees West thirty one Chains and fifty Links to a pine tree then W West thirty one Chains and fifty Links to a pine tree then N North twenty one Degrees West thirty three Chains and fifty Links to a pine tree then N North eighty five Degrees West twenty three Chains to a pine tree then S South twenty Degrees West five Chains to a pine tree then S South five Degrees West ten Chains to a pine Corner to the E. Elijah Clark's Survey and twenty acres surveyed for John and Vincent West then N North twenty five Degrees West sixteen Chains to a White Oak Sapling then S South sixty degrees West sixteen Chains and fifty Links to a pine tree then W West sixteen Chains and fifty Links to a spot in the line of the said John & Vincent's West one hundred and eighty acres Survey then the line of the same Survey N North thirty six Degrees West ten Chains to a Dead Black Oak then along their line again S South sixty six Degrees West twenty four Chains to a black Oak then N North twenty two Degrees West twenty Chains to a White Oak then S South eighty Degrees East eighteen to a pine tree EW comes to the said West 181 acres survey then N North eighty eight Degrees West twenty one Chains and fifty Links to a white oak Corner to one hundred acres surveyed to Javarius Noas and two hundred acres surveyed for the said John & Vincent West then S South eighty Degrees West twenty Chains to a spot in George Morphis line then N North

171
49
1539
1026
11799
5899

90
43
26
72
170
528
384
526
1447
1377

136
29
124
48
5304

1377
1290.3
886.1

Said John West 104 acres of alluvium N. 89. 30. W. 100. 00. S. 89. 30. E. 100. 00. N. Beginning at a pine tree then S South twenty Degrees West fifteen Chains to a pine tree then S South twenty Degrees and thirty minutes West twenty three Chains to a White Oak Sapling then EW standing about 200 Chains from the North side the Chesapeake on a Chesapeake branch Corner about one hundred and eighty acres surveyed for John & Vincent West then N North twenty eight Degrees East eight Chains to a pine tree EW standing by the side of a hollow then S South eighty Degrees East twelve to a pine tree then N North eighty four Degrees East eleven Chains to a pine tree then S South sixty Degrees East twenty five Chains to a pine tree then E East one hundred and ten Chains to a pine tree then N North eighty five Degrees East twenty seven Chains to a pine tree then N North eighty five Degrees East eighteen Chains

100
 180
 100
 200
 68
 133
 10.2.0
 16.
 181.1.0
 57
 70
 75
 17
 25
 50

 1190.3.0
 104

 1294



In pursuance of an order to me Directed bearing date the tenth day of May one Thousand seven hundred and Seventy one Requiring me to Survey unto the Deviser of Abraham Porter or his Assigns the Quantity of two Hundred and fifty acres of Unappropriated Land Below the falls of Delaware River at Trenton and by Virtue of a conveyance from John Stow (Deviser of the said Abraham Porter) unto John West of the same two Hundred and fifty acres By Deed dated the twenty first Day of September 1772 I have surveyed for the said John West part thereof situate in the County of Gloucester in the Western Division of New Jersey a Tract of Land Between Newcachegge (whereon John West's Saw Mill is Erected) and Machicoctason two Branches of Little Egg Harbour River and is Bounded as follows Viz Beginning at a pine letter EW standing by the North side the R. Newcachegge Creek a little below the Sawmill and about six perches below a small gully and from thence Running 1) North twenty seven Degrees East forty two Chains to a pine letter T. G. Corner to Sixteen acres surveyed to Thomas & David Clark standing by the South side the Goose ponds then along the South side thereof 2) North fifty Nine Degrees thirty Minutes West fifty Nine Chains seventy Links to a pine and over Dam then still up the same 3) North fifty eight Degrees West twenty three to a pine letter EW then 4) North thirty four Degrees and thirty Minutes West fifteen Chains to a pine letter E. G. Corner to one hundred and thirty three acres surveyed to Elijah Clark then along the

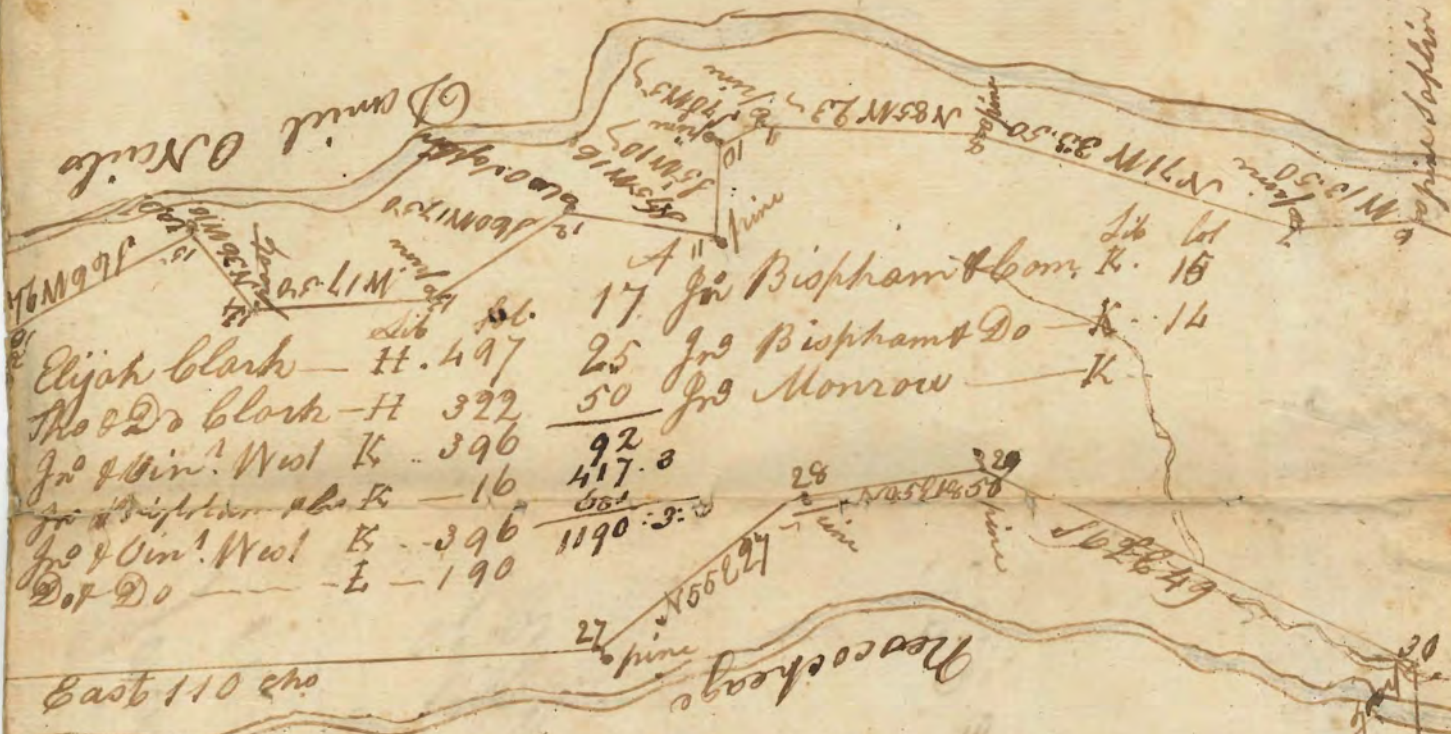

Said Elijah Clarks line ^{10th} North sixty five Degrees West thirty one chains and fifty links to a pine sapling then ^{11th} West thirty one chains and fifty links to a pine then ^{12th} North seventy one Degrees West thirty three chains & fifty links to a pine sapling then ^{13th} North eighty five Degrees West twenty three chains to a pine then ^{14th} South twenty Degrees West five chains to a pine then ^{15th} South five degrees West ten chains to a pine corner to the D. Elijah Clarks survey and twenty acres surveyed for John and Vincent West then ^{16th} North seventy five Degrees West sixteen chains to a white oak sapling then ^{17th} South sixty degrees West sixteen chains and fifty links to a pine then ^{18th} West sixteen chains & fifty links to a post in the line of the said John & Vincent West one hundred and eighty acres survey then ^{19th} the line of the same survey ^{20th} North thirty six Degrees West ten chains to a Dead Black Oak then along their line again ^{21st} ^{along} Sixty six Degrees West twenty four chains to a black oak then ^{22nd} ^{to} North seventy two Degrees West twenty chains to a white oak then ^{23rd} South eighty Degrees West eighteen to a pine letter EVW corner to the said West 181 acres survey then ^{24th} North eighty eight Degrees West twenty one chains and fifty links to a white oak corner to one hundred acres surveyed to Daverus Noas and two hundred acres surveyed for the said John & Vincent West then ^{25th} South eighty Degrees West twenty chains to a post in George Marples line then ^{26th}

171
69
1539
1026
11799
589-9

90 43
30
73
90
6570
3285
589
530
1447
70
1377

52
26
78
136
39
1224
408
5304
1377 added
8 out 1290-3
086-1



to
 (20) South twenty Degree West
 fifty chains to a pine letter E W corner
 to the said George Marpole then (21) South twenty three
 Degree and thirty minutes West twenty three chains
 to a white oak Coplin letter E W standing about 100
 chains from the North side the Cedar swamp on Newco
 Cheage Branch corner to about
 acres surveyed for John & Vincent West then (22)
 North seventy eight Degree East eight chains to
 a pine letter E W standing by the side of a hollow then
 (23) South eighty Degree East twelve chains to a pine then (24)
 North eighty four Degree East eleven chains to a
 pine then (25) South sixty Degree East twenty five
 chains to a pine then (26) East one hundred & ten
 chains to a pine near Thome Causeway corner to
 the one hundred and eighty acres survey a forward of
 the said John & Vincent West then along their line (27)
 North fifty five Degree East twenty seven chains to a
 pine then (28) North eighty five Degree East eighteen
 chains -

Chains and fifty Links to a pine then 20th South sixty
two Degrees East forty nine Chains to a post then
30th South twenty five Chains to a pine letter. SW corner
to two hundred and forty four acres Surveyed for John
Bispham & Company this 1st South eighty Degrees
East twenty five which pine stands about three
Chains from the North of Dividals of Old Cedar
swamp and about two Chains Westely from a large
pond then along the edge of the low land of the former
Old Cedar swamp 31st South eighty Degree East seven
ty five Chains to the first mentioned Branch then
Down the same Branch the several Courses
thereof to the Beginning Containing after Deduct
ing out the following Survey viz One Hundred
acres Surveyed to Laverius Noax Recorded in Lib. K
folio 345 one hundred & eighty to John Bispham
& Company in Lib. H folio 452 One hundred
acres to the John Bispham & Company in Lib. K
fol. 18 two hundred acres to John & Vincent West
in Lib. N fol. 36 sixty eight acres to the D. John &
Vincent West. in Lib. E folio 363 one hundred and
thirty three Acres to Elijah Clark in Lib. H folio
497 Eighteen acres and a half to Elijah Clark in
Lib. H folio 497 Sixteen acres to Thomas & David
Clark in Lib. H folio 392 one hundred and eighty
one acres & one Quarter to the D. John and Vincent
West in Lib. K folio 396 fifty seven acres to John
Bispham & Company in Lib. K folio 16 Seventy
acres to John & Vincent West in Lib. K folio 396
Seventy five acres to John & Vincent in Lib. E folio 190
Seventeen to John Bispham & Company in Lib. K
folio 15 twenty five acres to John Bispham and
Company in Lib. K folio 14 fifty acres to John
Monrow in Lib. K folio one hundred and four
acres and Allowance for Highway Surveyed.
the 13th 14th & 15th days of October 1772

To Daniel Smith
Surveyor General

P Am Ridgway Dep. Sur.

100
180
100
200
68
133
18.2.0
16.
181.1.0
57
70
75
17
25
50

1190.3.0
104

1294

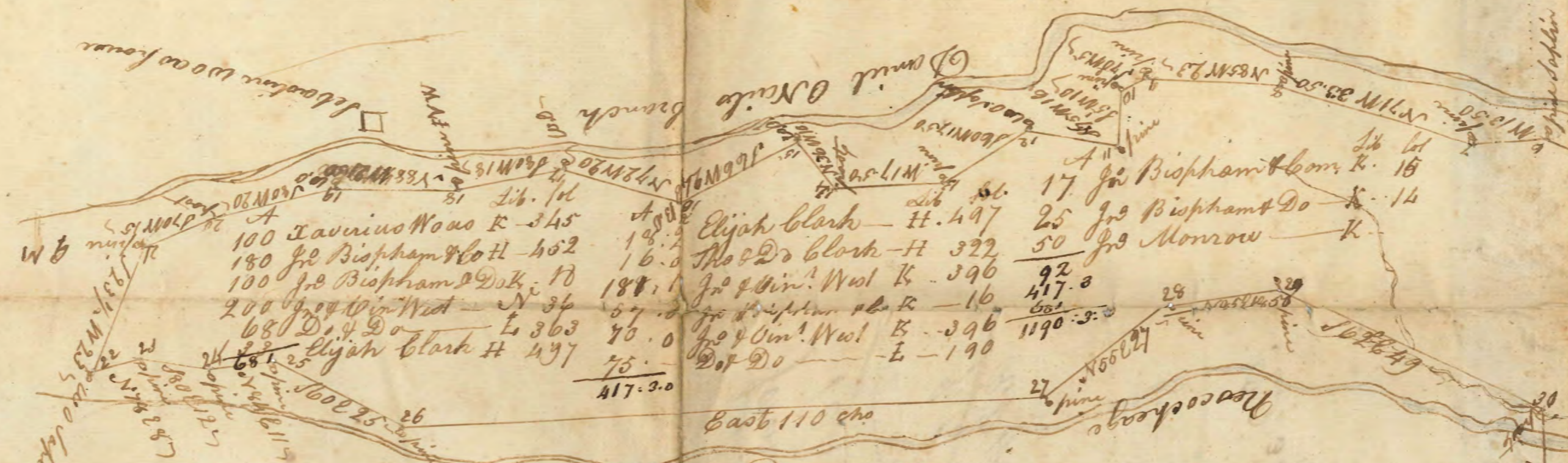

In pursuance of an order to me Directed bearing date the tenth day of May one Thousand seven hundred and Twenty one Requiring me to Survey unto the Deviser of Abraham Porter or his Assigns the Quantity of two Hundred and fifty acres of Unappropriated Land Below the falls of Delaware River at Trenton and by Virtue of a conveyance from John Stow (Deviser of the said Abraham Porter) unto John West of the same two Hundred and fifty

Said Elijah Clarks line 15th North sixty five Degrees West thirty one chains and fifty links to a pine Saplin then 16th West thirty three chains and fifty links to a pine then 17th North seventy one Degrees West thirty three chains & fifty links to a pine Saplin then 18th North eighty five Degrees West twenty three chains to a pine then 19th South seventy Degrees West five chains to a pine then 20th South five degrees West to

16
 345
 452
 18
 34
 363
 497
 417.3.0

17 for Bishopham & Com. K. 18
 25 for Bishopham Do K. 14
 50 for Morrow K.
 92
 417.3
 551
 1190.3.0
 190

17 for Bishopham & Com. K. 18
 25 for Bishopham Do K. 14
 50 for Morrow K.
 92
 417.3
 551
 1190.3.0
 190

directed base
 hundred
 Division
 of two
 and Below
 lister of
 Abraham
 and fifty
 September
 West
 Newchegg
 Maccheca

Said Elijah Clarke line 5th North sixty five Degrees West thirty
 one chains and fifty links to a pine Saplin then 6th West
 thirty chains and fifty links to a pine then 7th
 North seventy one Degrees West thirty three chains
 & fifty links to a pine Saplin then 8th North eighty five Degrees
 West twenty three chains to a pine then 9th South seventy Degrees
 West five chains to a pine then 10th South five degrees West
 ten chains to a pine corner to the D. Elijah Clarke survey
 and seventy acres surveyed for John and Vincent West
 then 11th North twenty five Degrees West sixteen chains to a
 white Oak Saplin then 12th South sixty degrees West seventeen
 chains and fifty links to a pine then 13th West seventeen chains &

Beginning
 120th South twenty Degrees West
 fifty chains to a pine lettered E.W. corner
 to the said George Marpole then 21st South twenty three
 Degrees and thirty minutes West twenty three chains
 to a white Oak Saplin lettered E.W. standing about 100
 chains from the North side the Cedar swamp on Newca

171	90	43	52	136
69		30	26	39
1539		73	78	1224
1026		40		408
11799		6570		5304
585		3285		
		584		
		530		
		1447		
		70		
		1377		
				1377 added
				1290.3.
				880

