

INLETS, TYPE E1 AND TYPE E2 TO BE OF THE SAME CONSTRUCTION AND DIMENSIONS AS INLET TYPE E, EXCEPT AS OTHERWISE INDICATED BELOW.

CLASS B CONCRETE SLAB WITH #3 REINFORCEMENT STEEL 6" C/C BOTH WAYS.

NOTE:

CONSTRUCT FOUNDATION AND INVERT IN TWO STAGES. LEAVE TOP SURFACE OF STAGE 1 ROUGH.

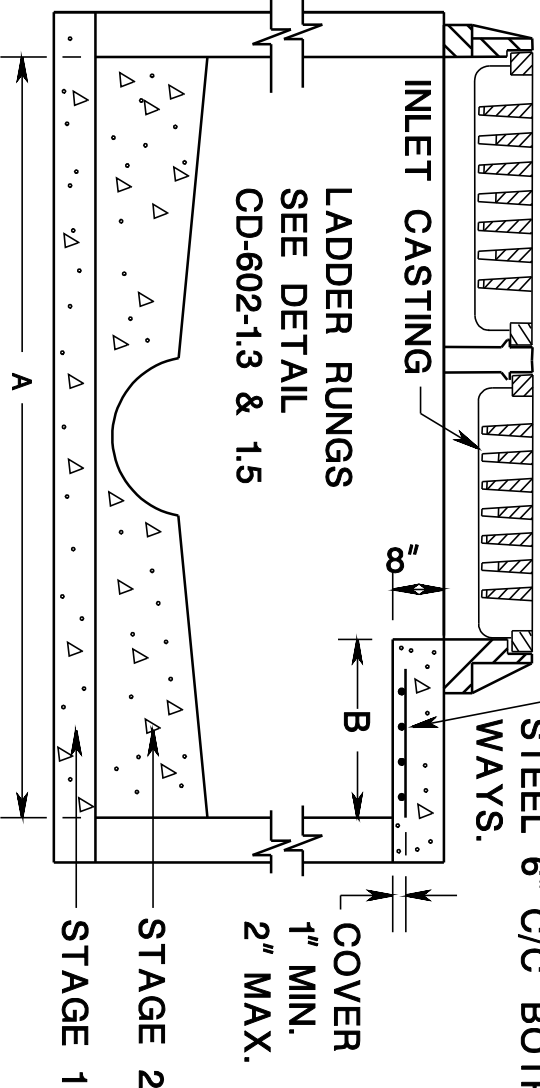

INLET TYPE	DIMENSION A	DIMENSION B
E 1	4'-6"	1'-0"
E 2	5'-6"	2'-0"

INLETS, TYPE E1 AND TYPE E2 CD-602-4.1

FRAME AND GRATES

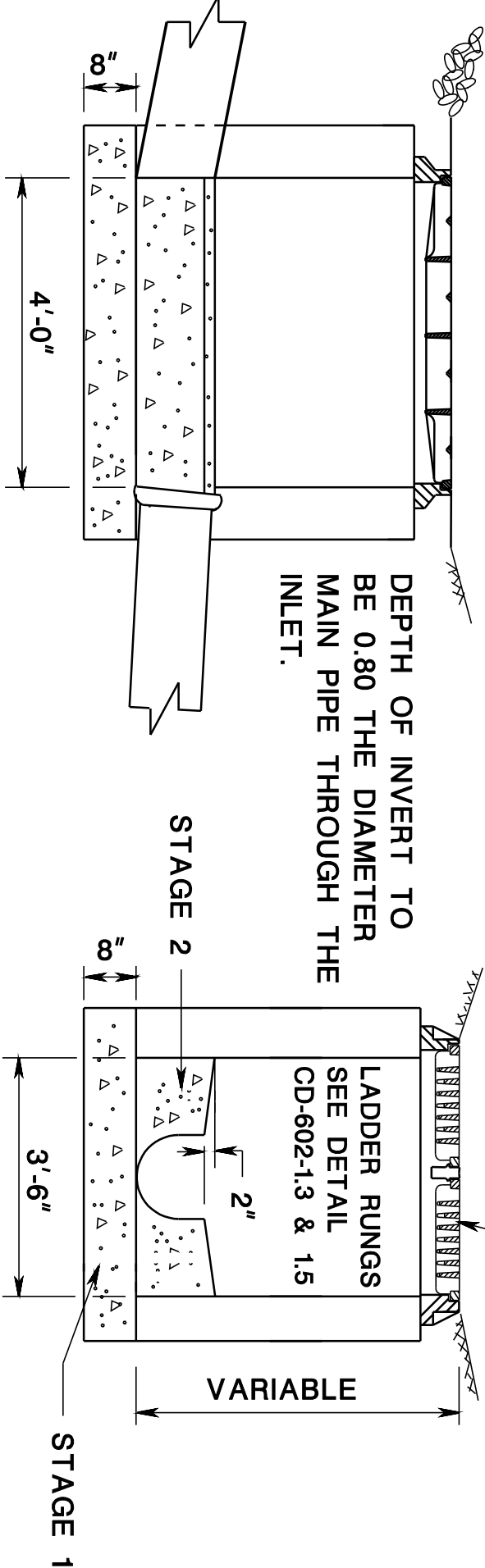
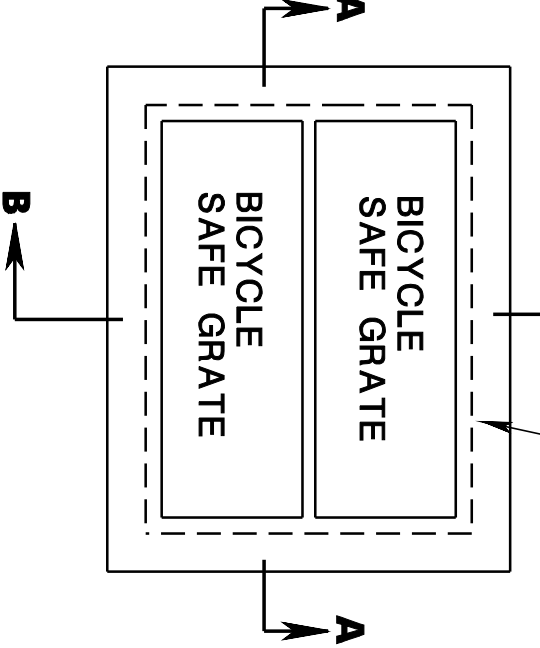

SECTION A-A

SECTION B-B

NOTE: CONSTRUCT FOUNDATION AND INVERT IN 2 STAGES. LEAVE TOP SURFACE OF STAGE 1 ROUGH.

CD-602-4.2

FRAME AND TWO GRATES

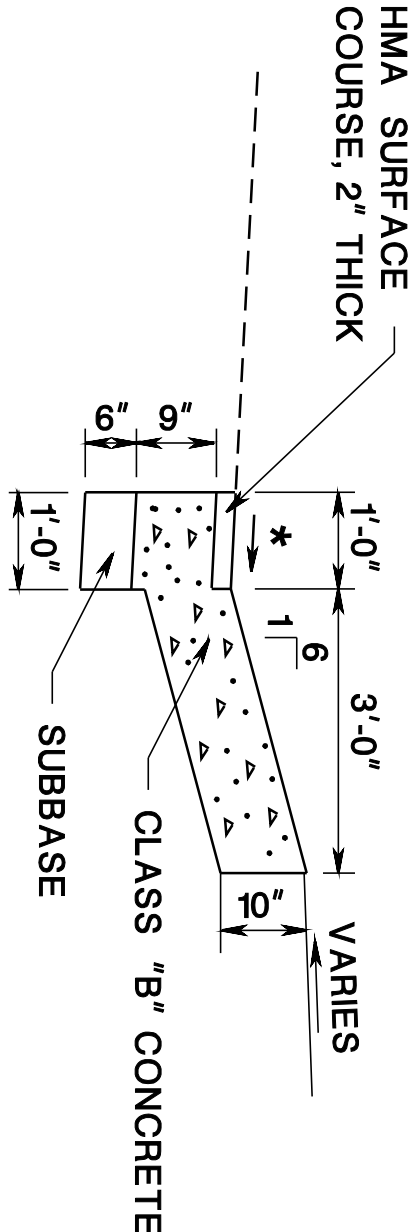

SECTION A-A

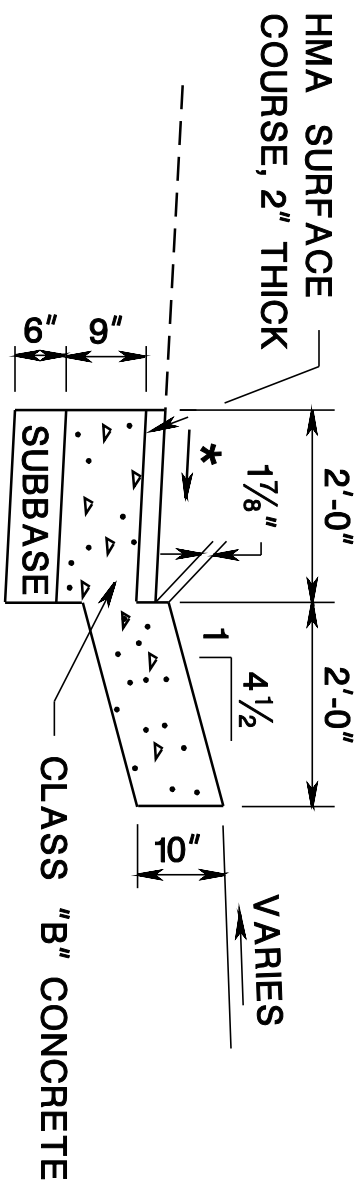

SECTION B-B

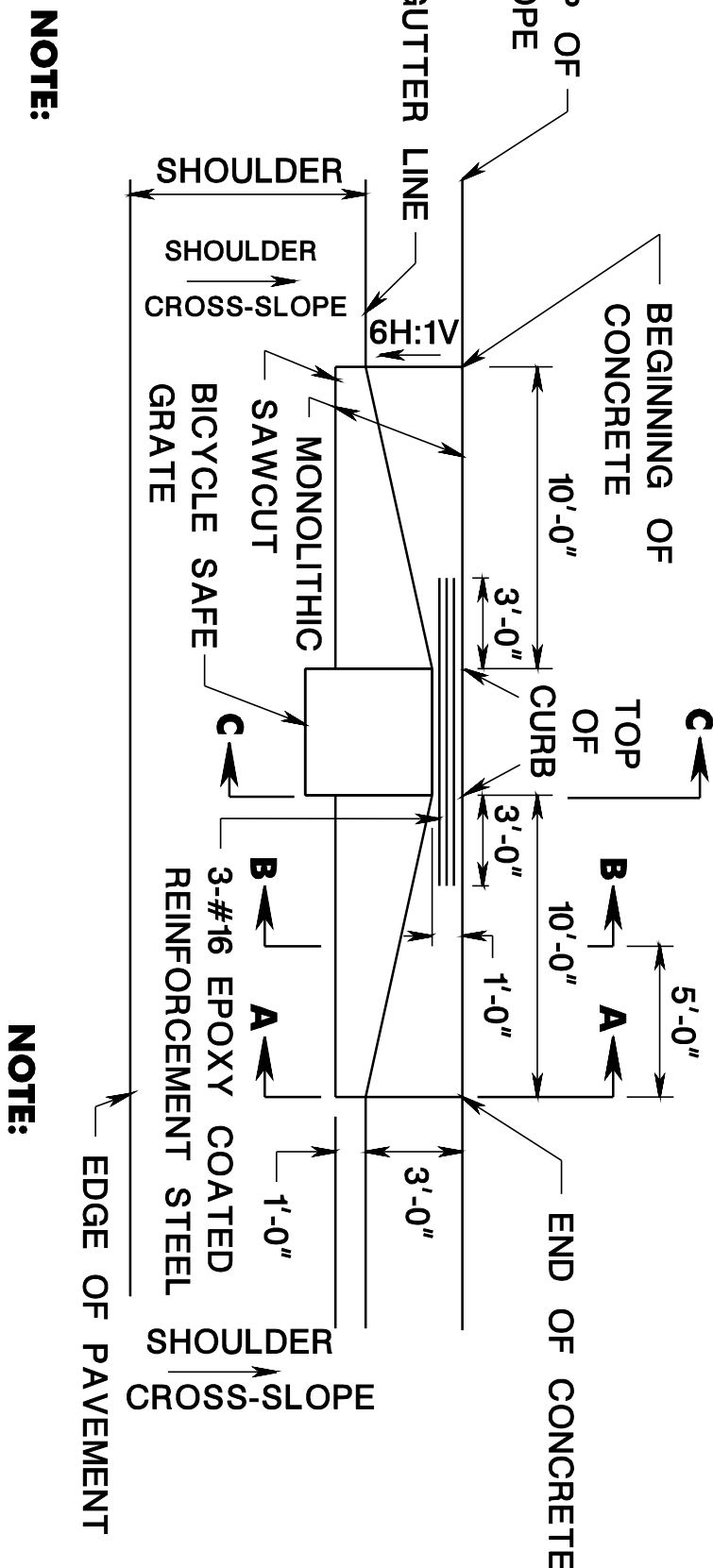

NOTE:

SHAPE THE UNDERLYING MATERIAL AND COMPACTED TO A FIRM, EVEN SURFACE.

PLAN VIEW

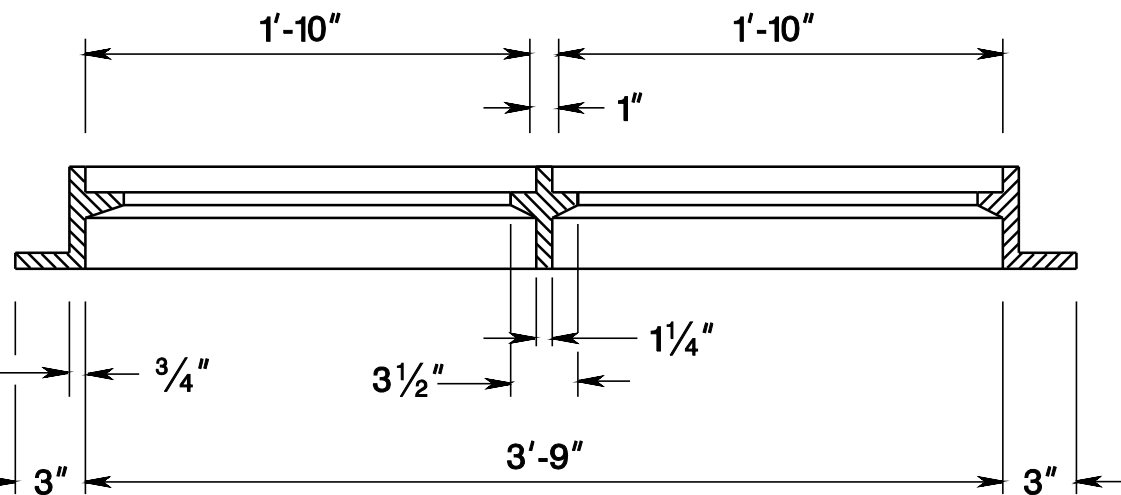

SECTION B-B

WEIGHT OF FRAME = 435#  
WEIGHT OF EACH GRATE = 300 ± 15 LBS

INLET, TYPE ES CD-602-4.4

\* SAME CROSS-SLOPE AS ADJOINING SHOULDER

GENERAL NOTE:

1. SEE GENERAL NOTES AT CD-602-1.6.

CD-602-4.6

FRAME FOR INLET, TYPE E

SECTION A-A

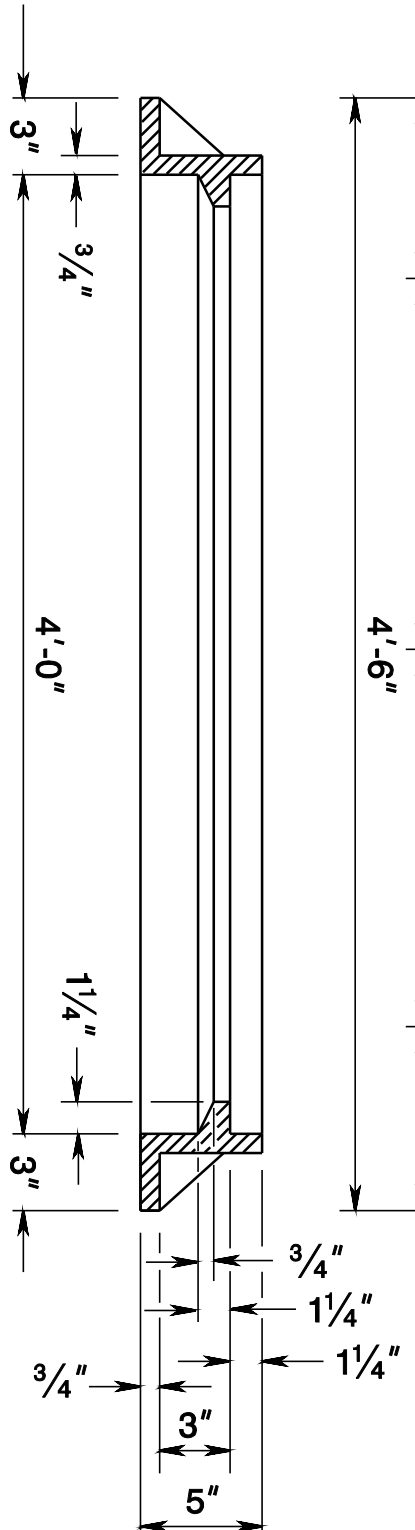

CD-602-4.3

SECTION C-C

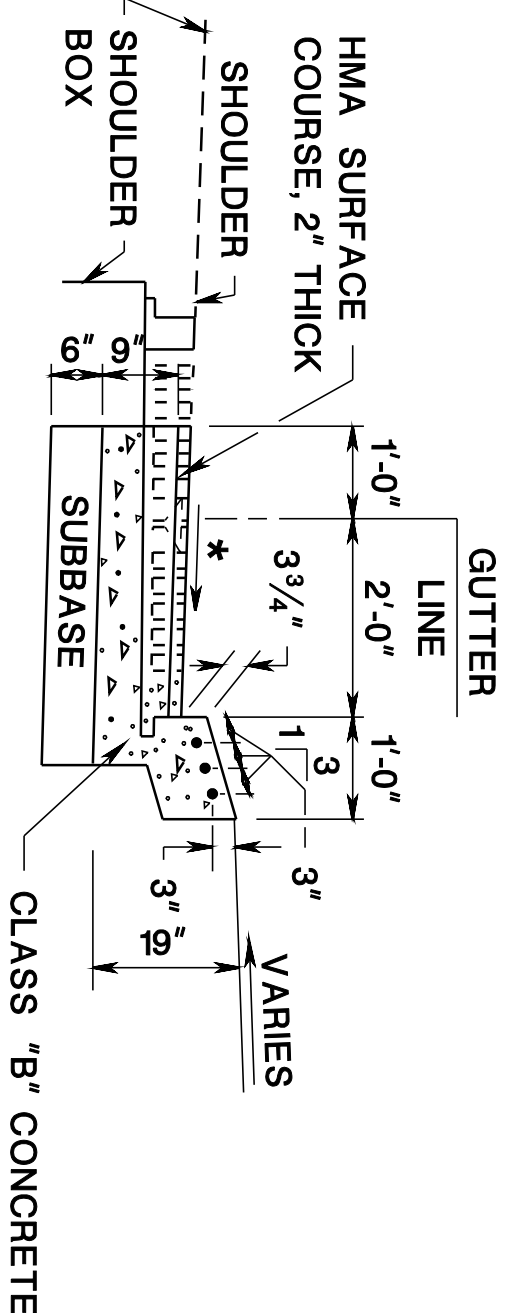

INLETS, TYPE E, E1, E2, & ES

N.T.S.

CD-602-4

NEW JERSEY DEPARTMENT OF TRANSPORTATION

CONSTRUCTION DETAILS

FOR EXISTING INLET TYPE "B", PROVIDE NEW INLET CASTING TYPE "E".  
FOR EXISTING INLET TYPE "E" OR "ES" USE EXISTING CASTING.

NOTE:

SHAPE THE UNDERLYING MATERIAL AND COMPACT TO A FIRM, EVEN SURFACE.

PLAN VIEW

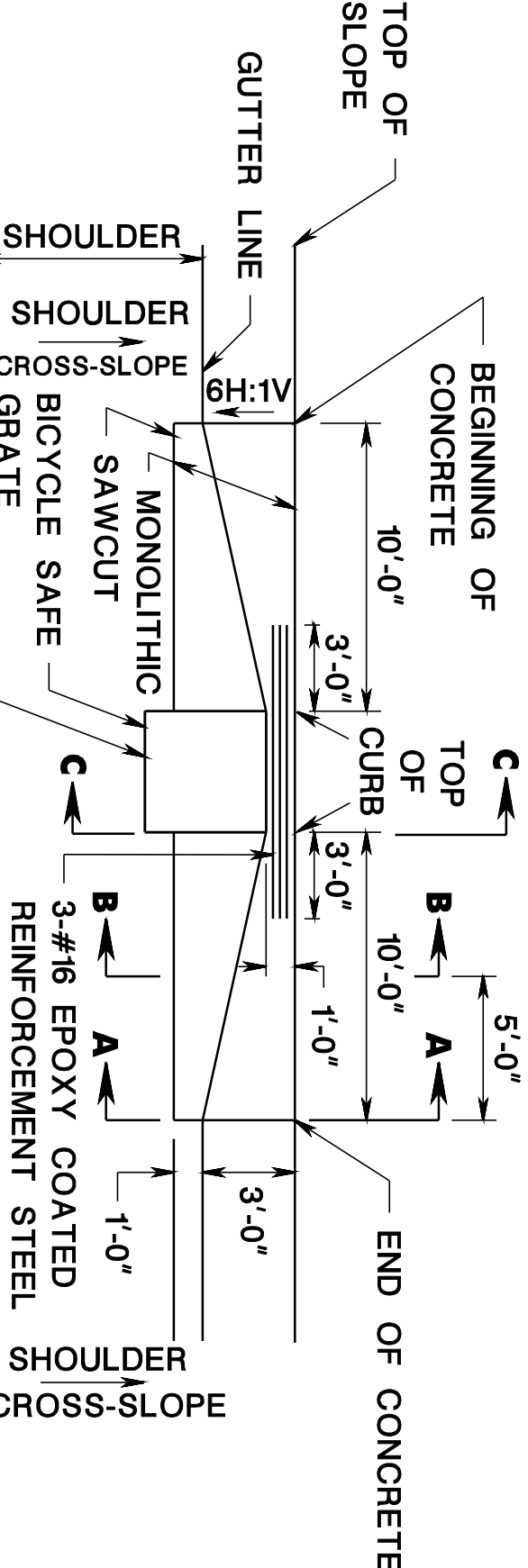

SECTION A-A

\* SAME CROSS-SLOPE AS ADJOINING SHOULDER

SET INLET TYPE ES, CASTING

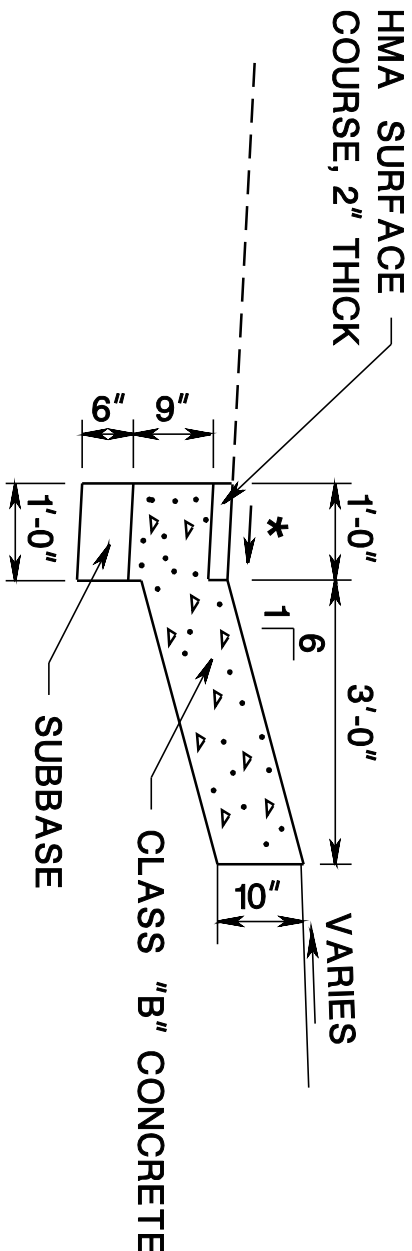

SECTION B-B

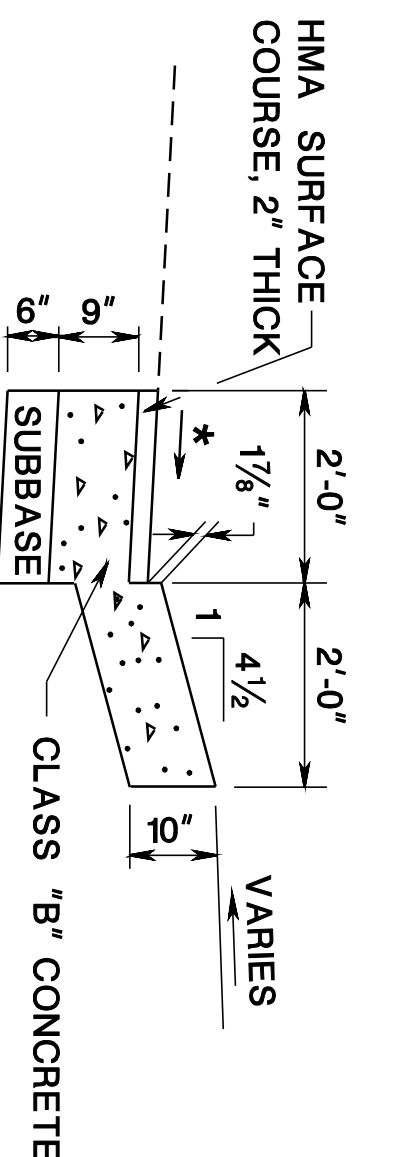

BDC24D-04 - REMOVED NOTES CD-602-4.3, CD-602-4.4, CD-602-4.5, AND NOTE: REINFORCEMENT STEEL IS IN METRIC UNITS".  
BDC16D-01-ORIGINAL SHEET